



# TAI-SAW TECHNOLOGY CO., LTD.

No. 3, Industrial 2nd Rd., Ping-Chen Industrial District,  
Taoyuan, 324, Taiwan, R.O.C.

TEL: 886-3-4690038 FAX: 886-3-4697532

E-mail: [tstsales@mail.taisaw.com](mailto:tstsales@mail.taisaw.com) Web: [www.taisaw.com](http://www.taisaw.com)

## Product Specifications Approval Sheet

Product Name: SAW Filter 428MHz 20MHz BW SMD 3.8×3.8mm

TST Parts No.: TA1675A

Customer Parts No.: \_\_\_\_\_

Company: _____
Division: _____
Approved by : _____
Date: _____

Checked by: \_\_\_\_\_ Andy Yu *Andy Yu*

Approval by: \_\_\_\_\_ Bob Chau *Bob Chau*

Date: \_\_\_\_\_ 2013/11/25

1. Customer signed back is required before TST can proceed with sample build and receive orders.
2. Orders received without customer signed back will be regarded as agreement on the specifications.
3. Any specifications changes must be approved upon by both parties and a new revision of specifications shall be released to reflect the change.



# TAI-SAW TECHNOLOGY CO., LTD.

No. 3, Industrial 2nd Rd., Ping-Chen Industrial District,  
Taoyuan, 324, Taiwan, R.O.C.

TEL: 886-3-4690038 FAX: 886-3-4697532

E-mail: [tstsales@mail.taisaw.com](mailto:tstsales@mail.taisaw.com) Web: [www.taisaw.com](http://www.taisaw.com)

## SAW Filter 428 MHz 20MHz BW SMD 3.8x3.8mm

MODEL NO.:TA1675A

REV. NO.:1.0

### A. MAXIMUM RATING:

1. Input Power Level: 10 dBm
2. DC Voltage : 5V
3. Operating Temperature: -30°C to +70°C
4. Storage Temperature: -40°C to +85°C

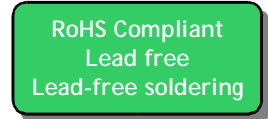

Electrostatic Sensitive Device (ESD)

### B. ELECTRICAL CHARACTERISTICS:

Item			Unit	Min.	Typ.	Max.
Center frequency	Fc	MHz		-	428	-
1dB Bandwidth		MHz	dB	20	27	-
VSWR			dB		1.7	2.0
Insertion loss	418 ~ 438	MHz	dB	-	2.0	3.3
Attenuation (reference from 0dB)						
10 ~ 155	MHz		dB	35	51	-
208 ~ 350	MHz		dB	30	55	-
350 ~ 368	MHz		dB	25	53	-
368 ~ 388	MHz		dB	15	52	-
470 ~ 490	MHz		dB	15	31	-
490 ~ 500	MHz		dB	25	42	-
500 ~ 600	MHz		dB	30	45	-
600 ~ 850	MHz		dB	27	43	-
Source impedance	Z <sub>S</sub>		Ω	-	50	-
Load impedance	Z <sub>L</sub>		Ω	-	50	-

### C. FREQUENCY CHARACTERISTICS:

#### Wideband response: (span 840MHz)

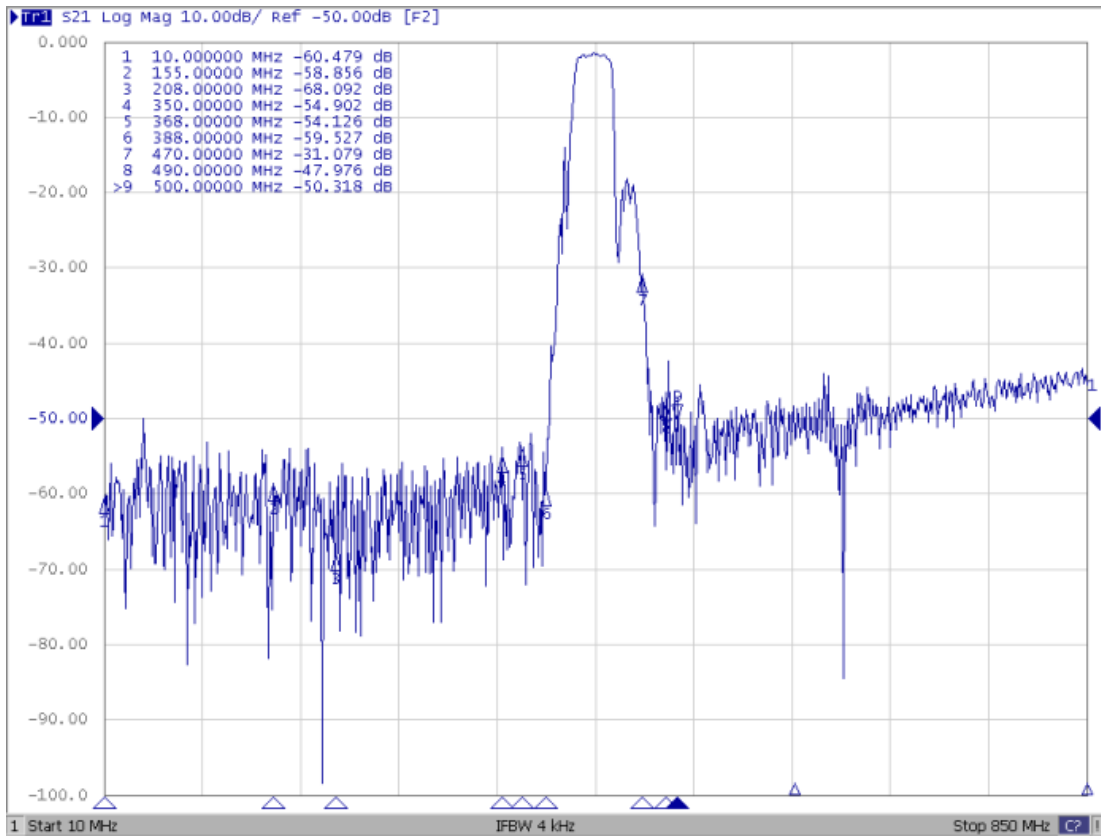

#### S21 response: (span 200MHz)

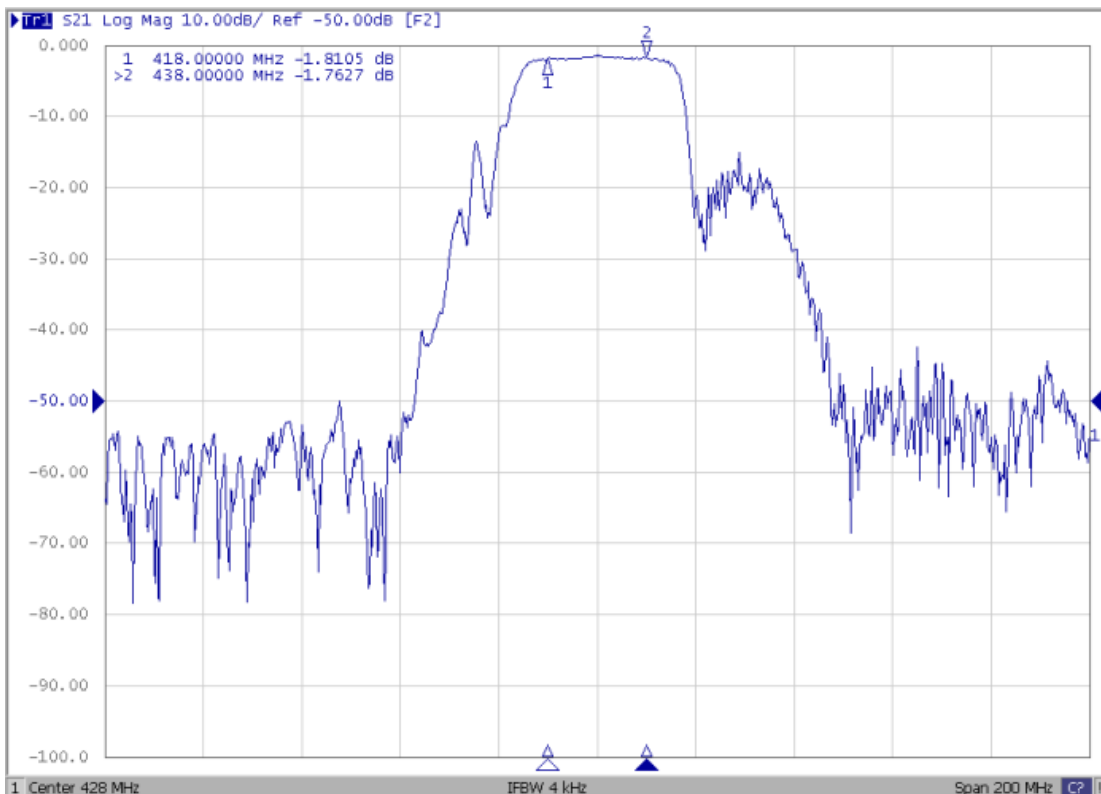

### Passband response: (span 60MHz)

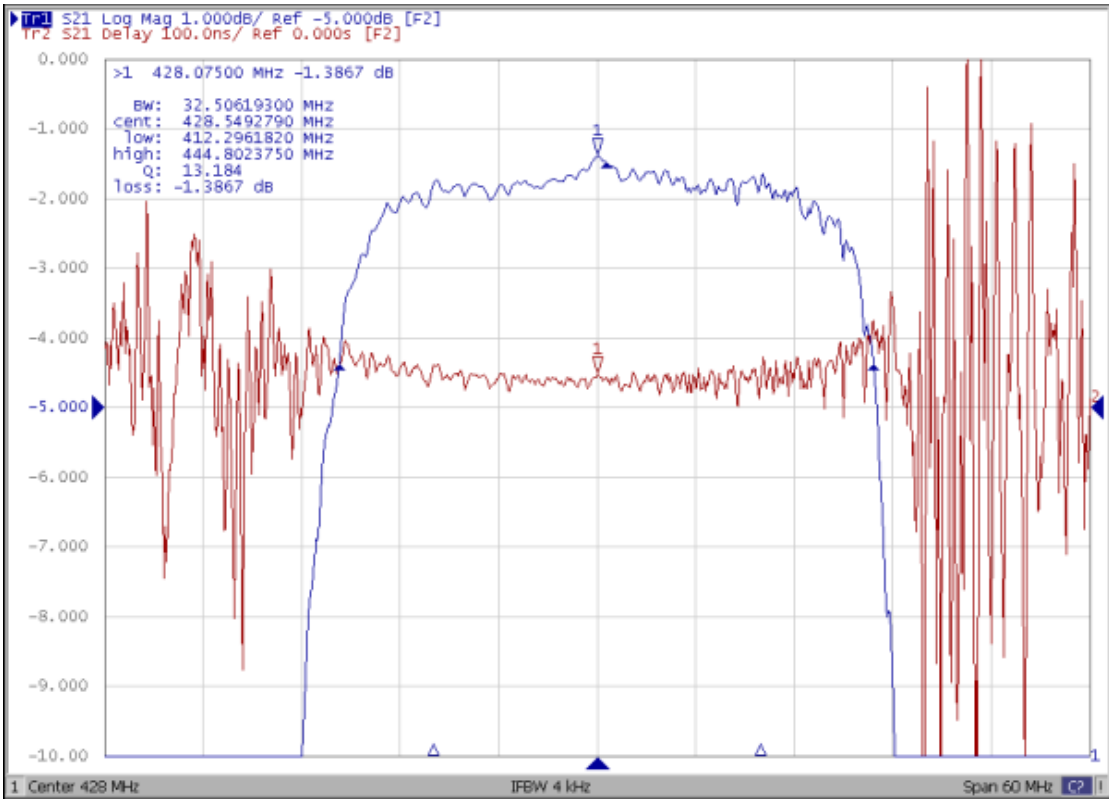

### S11 & S22 VSWR: (span 40MHz)

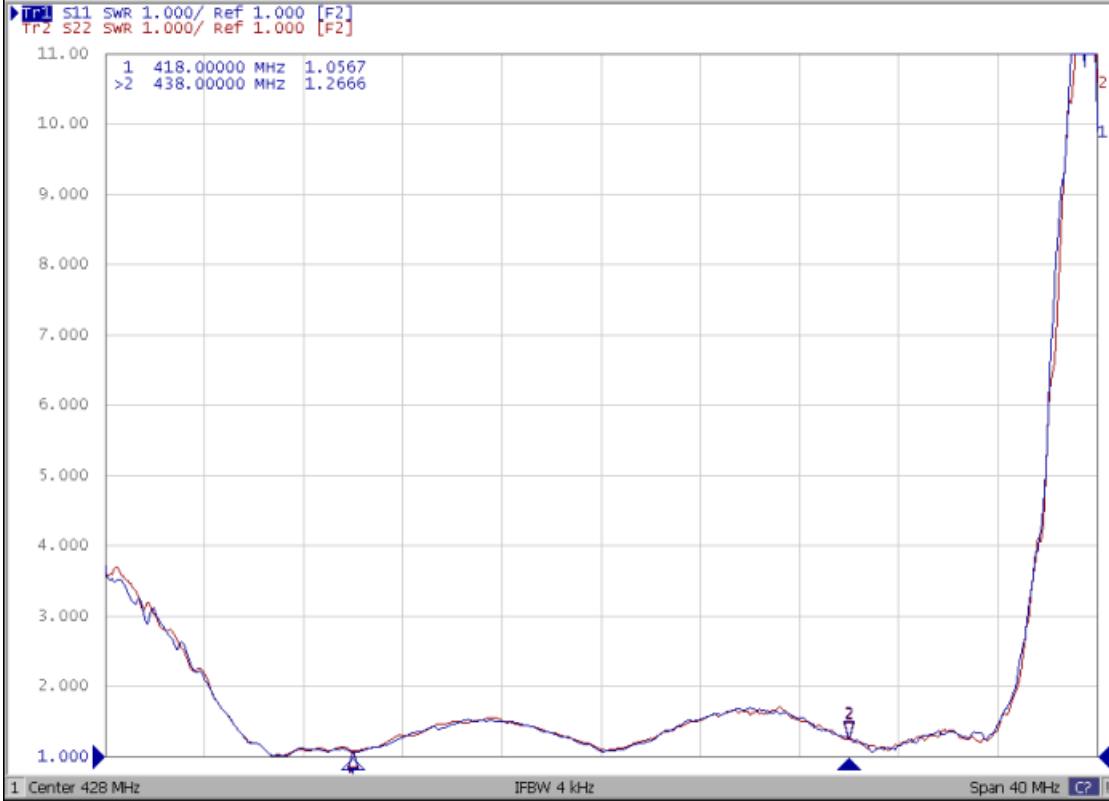

**D. MEASUREMENT CIRCUIT:**

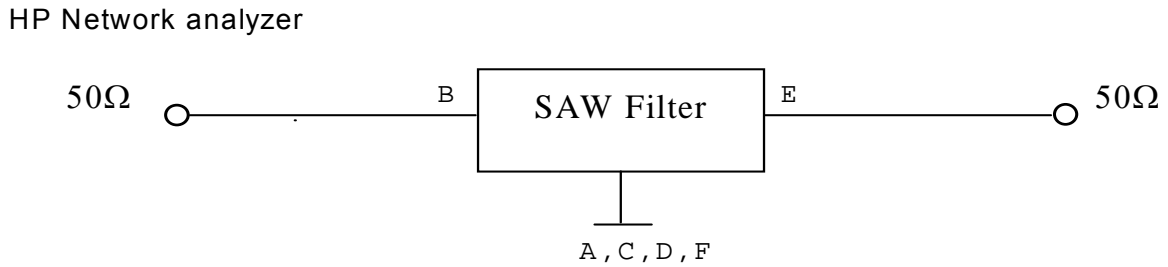

**E. OUTLINE DRAWING:**

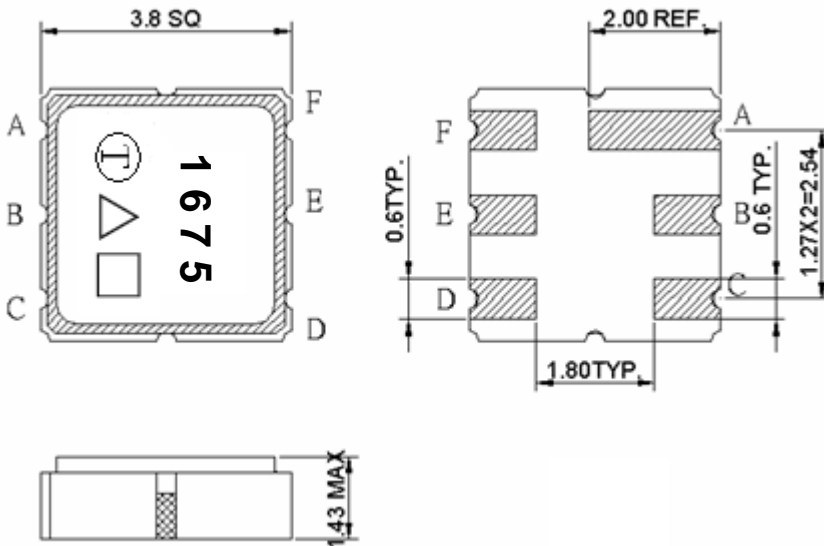

B : Input  
 E: Output  
 A,C,D,F Ground  
 △:Year Code  
 □: Date Code(Follow the table provided by planner each year.)  
 Unit: mm

△ Product Year Code

Year	2011	2012
	2013	2014
	2015	2016
Product Code	A	a

## F. PCB FootPrint

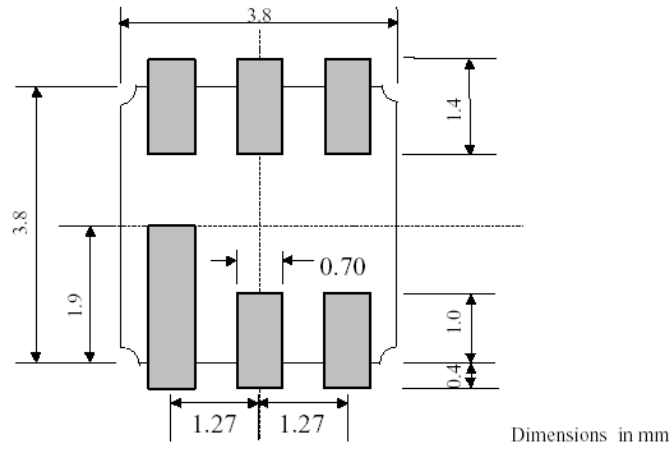

## G. PACKING:

### 1. REEL DIMENSION

(Please refer to FR-75D10 for packing quantity)

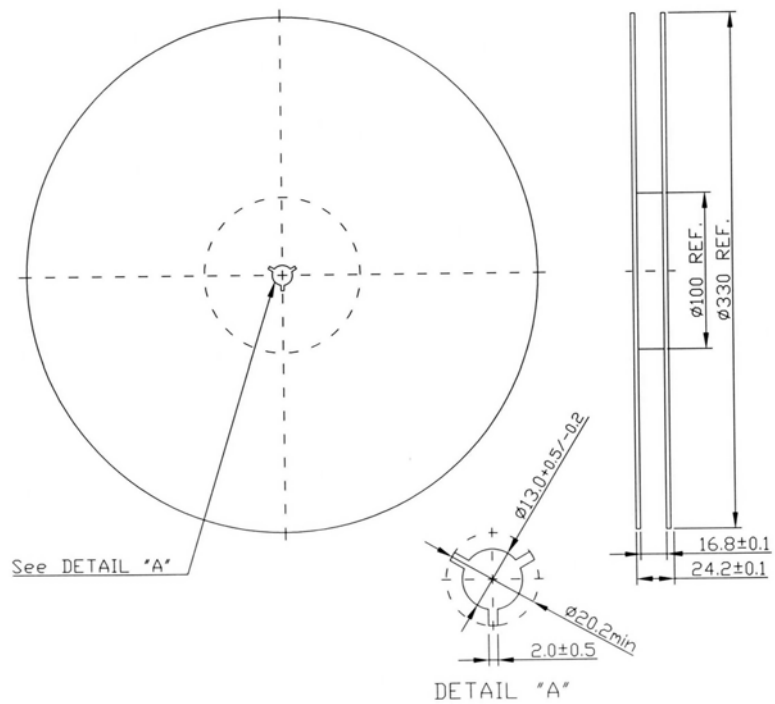

## 2. TAPE DIMENSION

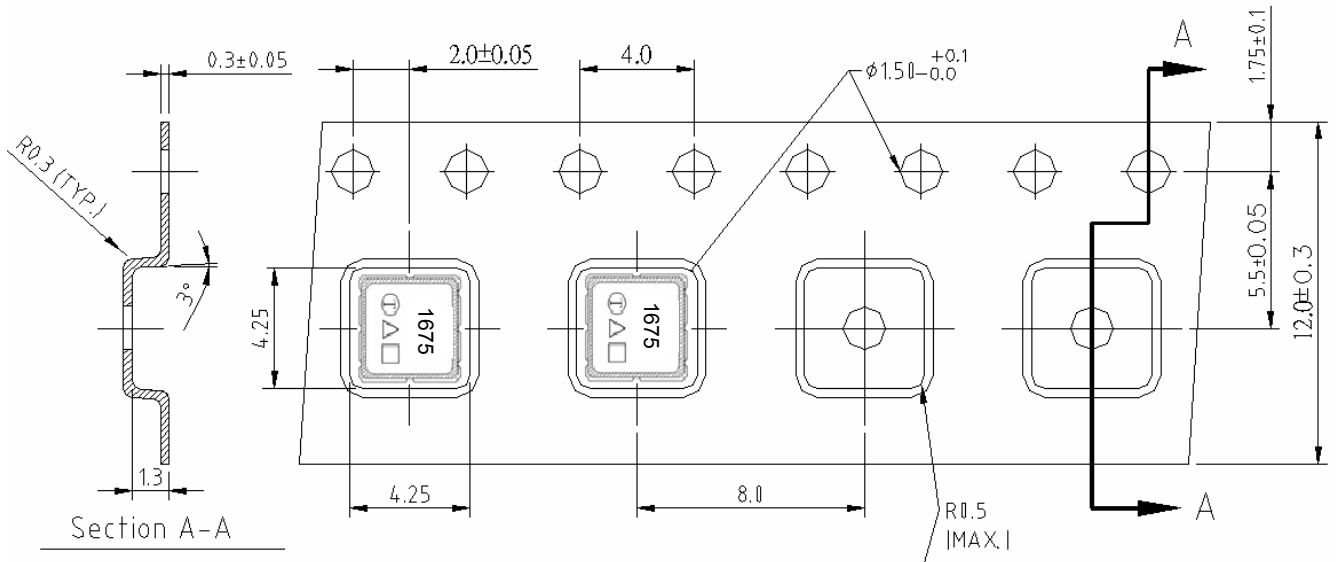

## H. RECOMMENDED REFLOW PROFILE :

