

Rev	AWO #	Description	Date	Appr
-		RELEASED	12/01/10	

APPROVED: _____
 DATE: _____ TITLE: _____

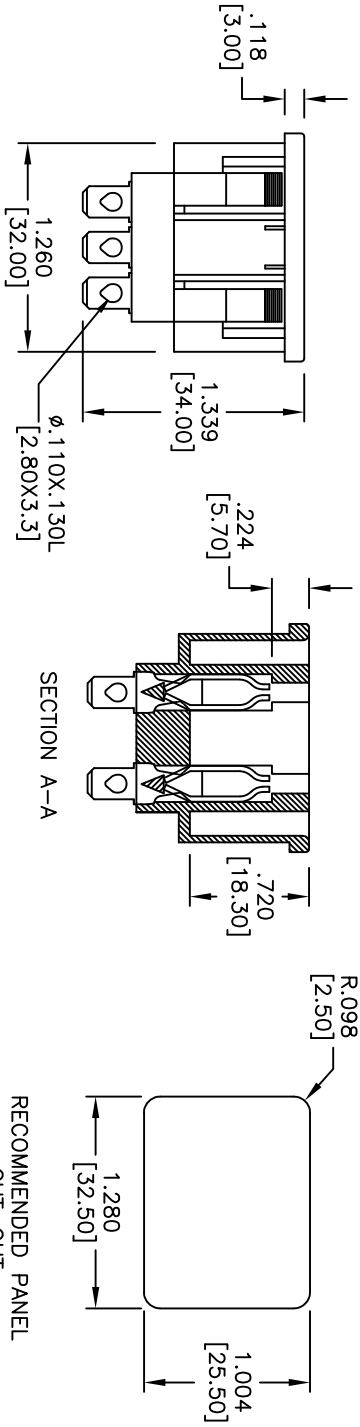
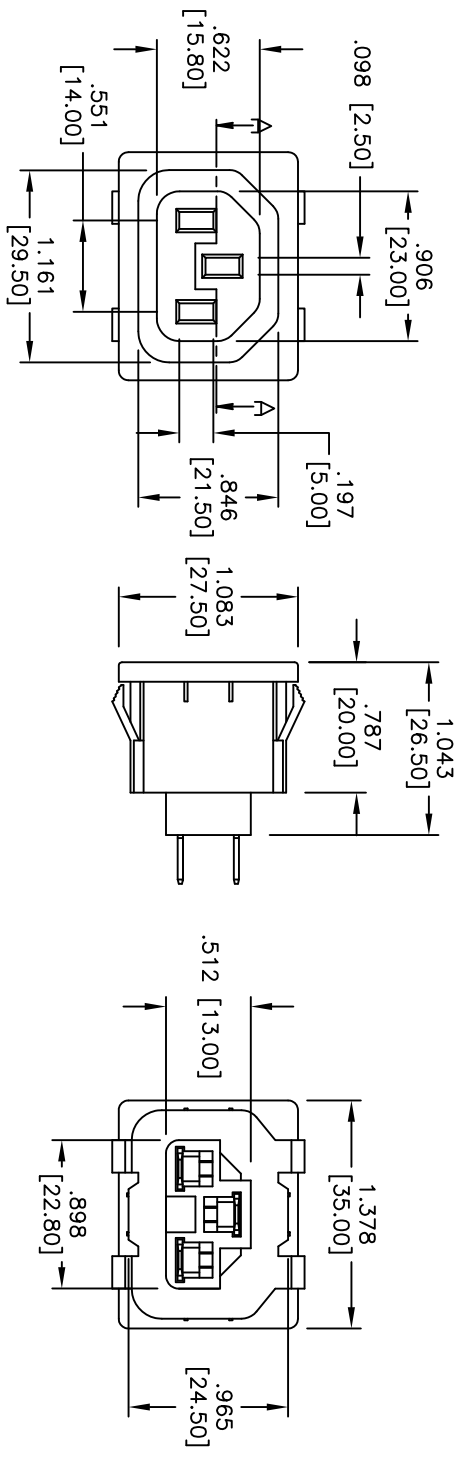

SPECIFICATIONS:

Material: Nylon 66, glass reinforced, rated UL 94V-0
 Insulator color: Black
 Contacts: Brass, Nickel plated
 Plating: Tin over Copper underplate overall
 Electrical:
 Operating voltage: 250 VAC
 Current rating: UL & CSA: 15 Amps max
 VDE: 10 Amps max
 Insulation resistance: 100 Mohms min @ 500 VDC
 Dielectric withstanding voltage: 2,000 VAC for 1 minute
 Temperature Rating:
 Operating temperature: -25°C to +70°C
 Environmental:
 Lead free, RoHS compliant



UNLESS OTHERWISE SPECIFIED ALL DIMENSIONS ARE INCHES [MM]	
TOLERANCES: EXCEPT AS NOTED	
INCHES	HOLDS
.X ± .10	ØX ± .10
.XX ± .020	ØXX ± .015
.XXX ± .015	ØXXX ± .010
APPROVALS	DATE
DRAWN	DY
CHECKED	
APPROVED	

ADAM TECH
 909 Railway Avenue, Union, NJ 07083
 Phone: 908-687-5000 Fax: 908-687-5710

TITLE: IEC FEMALE OUTLET, SNAP-IN PANEL MOUNT, SPECIAL CONTACT

SIZE: X PART NO.: IEC-D-1-EF-C2

REF: S00037T SCALE: NTS SHEET 1 OF 1