

DWG. NO. 01220			
REV.	DESCRIPTION	BY DATE	APPRO.
C	ECR 6401	6/22/00	[Signature]

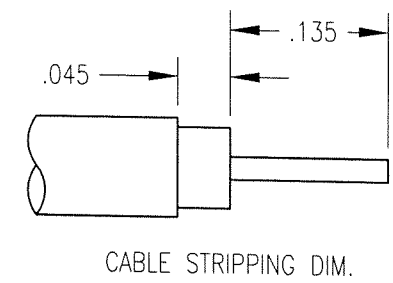
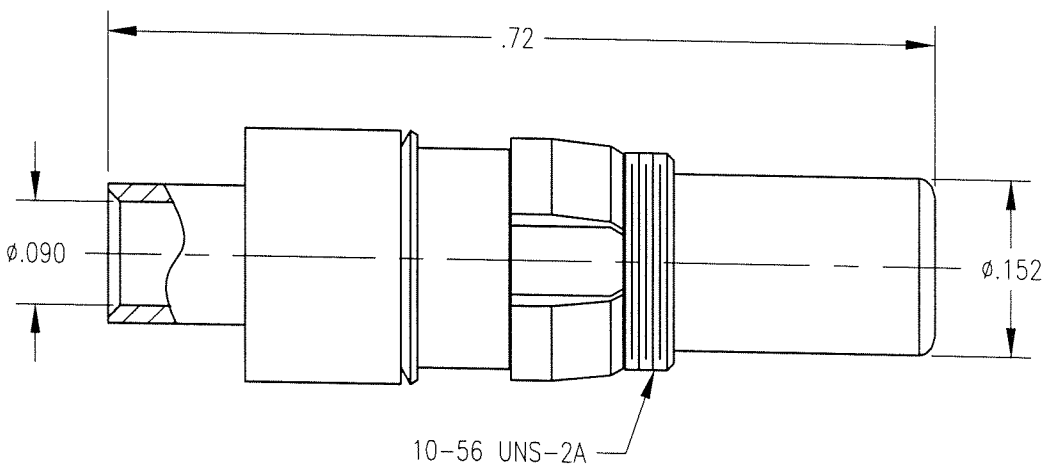
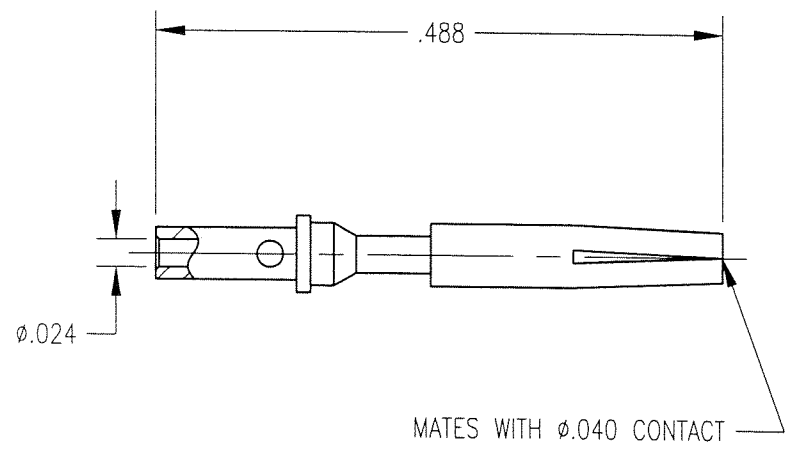

- NOTES:
- MECHANICAL:
 - MATERIALS:
 - BODY: BRASS PER ASTM B16
 - INSULATOR: TEFLON PER ASTM D1710
 - CONTACT: BERYLLIUM COPPER PER ASTM B196
 - CLIP RING: BERYLLIUM COPPER PER ASTM B194
 - SPRING WASHER: PHOSPHOR BRONZE PER ASTM B103
 - FINISH:
 - BODY AND CONTACT: .000030 MIN. GOLD PER MIL-G-45204 OVER .000050 MIN. NICKEL PER QQ-N-290
 - SPRING WASHER: .000005 MIN. GOLD PER MIL-G-45204 OVER .000050 MIN. NICKEL PER QQ-N-290
 - CLIP RING: .000100 MIN. NICKEL PER QQ-N-290 OVER COPPER FLASH
 - RETENTION IN HOUSING: 15 LBS MIN.
 - FOR USE WITH .086 SEMI-RIGID CABLE.
 - USE CABLE ASSEMBLY PROCEDURE 5-15.

PER ASME Y14.5M-1994 UNLESS OTHERWISE SPECIFIED: DIMENSIONS ARE IN INCHES (MM)				Litton	
TOLERANCES: DECIMALS xx ± .01/0.254 xxx ± .005/0.127 ANGLES ± 2'				Winchester/Retconn 400 Park Road Watertown, Connecticut 06795	
CUSTOMER DRAWING		SCALE: 6:1		TITLE RDM THREADED PLUG	
DRAWN EJW	DATE 4/14/98	CHECKED JMC	DATE 4/14/98	REV. C	
APPROVED PRP	DATE 4/14/98	APPROVED PRP	DATE 4/14/98	SHT. 1	OF 1