

RECOMMENDED PCB LAYOUT

- NOTES:
1. ALL DIMENSIONS IN MM
 2. GENERAL TOLERANCE: 0.0 ± 0.4
0.00 ± 0.25
 3. TERM. NOS. FOR REF. ONLY
 4. RATING: 50mA, @12V DC
 5. TRAVEL: 0.25 ± 0.1mm
 6. OPERATING FORCE: 250 ± 50gf
 7. CONTACT RESISTANCE: 100m ohms max.
 8. ELECTRICAL LIFE: 100,000 CYCLES MIN.
 9. INSULATION RESISTANCE: 100M ohms min.
 10. DIELECTRIC STRENGTH: 250V RMS MIN.
 11. OPERATING TEMP.: -30°C to +85°C
 12. ▲ DESIGNATE MAJOR DIMENSIONS

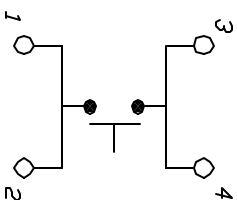
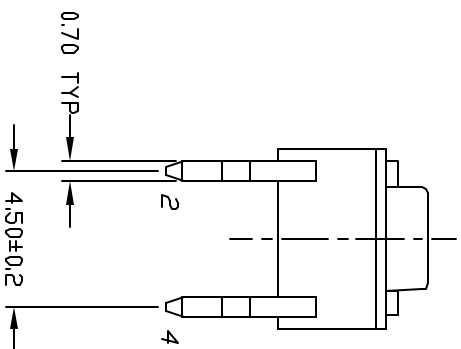
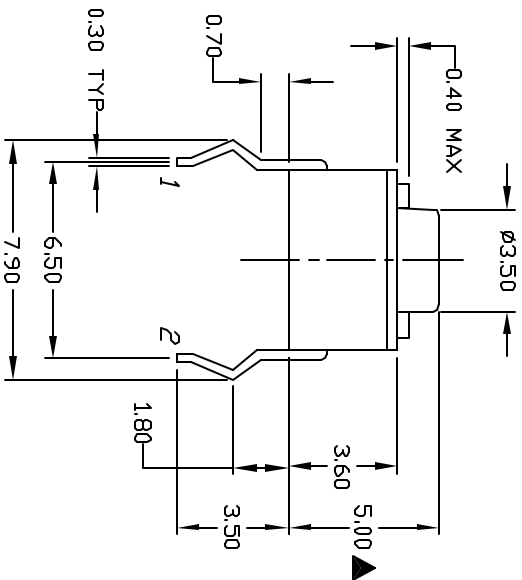

CIRCUIT: SPST
CONTACT CONFIGURATION

REV.	ECN NO.	DESCRIPTION	DATE	CHKD
C	10682	REVISED & REDRAWN	6/14/00	MM
THE INFORMATION CONTAINED IN THIS DOCUMENT IS PROPRIETARY TO E-SWITCH AND IS NOT TO BE COPIED OR TRANSMITTED				

TITLE	SCALE	DATE	DR	DWG	REV
TL 1105A F250 Q	4:1	8/14/96	MM	P010012	C

