

1. Mechanical Dimensions:

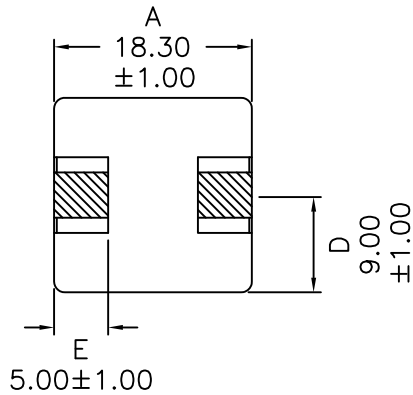

Bottom view

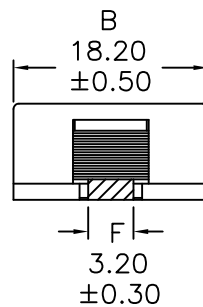

F = 3.20 ±0.30



Top view

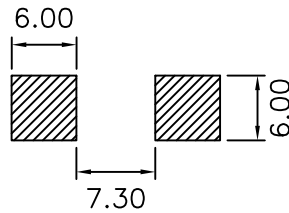

PCB Layout

Notes:

1. Solderability: Leads shall meet MIL-STD-202G, Method 208H for solderability.
2. Flammability: UL94V-0
3. ASTM oxygen index: > 28%
4. Insulation System: Class F 155°C. UL file E151556
5. Operating Temperature Range: All listed parameters are to be within tolerance from -40°C to +125°C
6. Storage Temperature Range: -20°C to +40°C
7. Aqueous wash compatible
8. SMD Lead Coplanarity: ±0.004"(0.102mm)
9. Electrical and mechanical specifications 100% tested
10. RoHS Compliant Component
11. Recommended IR Reflow peak temp of 245C Max.

2. Schematic:

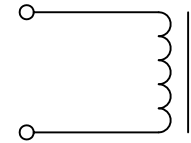

3. Electrical Specifications: @25C

OCL: 15uH ±20% @100KHz 10mA

Q: 20 Min @10KHz 50mV

Rated inductance: 12uH Typ @100KHz 10mA @14A

Rated current: 14A Max (Based on 50°C Rise in Temp)

I_{sat}: 14A Typ (Based on 30% drop in OCL Max)

DCR: 9.72 mOhms Max

SRF: 14MHz Typ

DOC. REV: A/2

XFMRS Inc www.XFMRS.com	Title: SMD Flat Wire High Current Inductor		
	UNLESS OTHERWISE SPECIFIED TOLERANCES: .xx ±0.25 Dimensions in MM	P/N: XFHCL32-150M	REV. A
	DWN.	Yuan	Jun-06-13
	CHK.	YK Liao	Jun-06-13
SHEET 1 OF 1	APP.	Joe Huff	Jun-06-13