

# New Jersey Semi-Conductor Products, Inc.

20 STERN AVE.  
SPRINGFIELD, NEW JERSEY 07081  
U.S.A.

TELEPHONE: (201) 376-2  
(212) 227-6  
FAX: (201) 376-8

## PARAMETERS

REF/REG DIODE, 400MW < P(D) < 1W 1N5998C

Description: Ref/Reg Diode, 400mW < P(D) < 1W

Mil/High-Rel? (Y/N).....	
Nom. Ref. Volt.....	8.2
Test Current.....	5.0m
Tol. (%).....	2
PD Max. (W).....	500m
Dyn. Zmax (j).....	7.0
Temp Coef pp/10k.....	
Oper. Temp (x C) Max.....	200u
Pkg Style.....	D0-35
Surface Mounted (Y/N).....	N

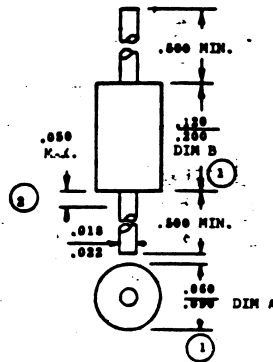

1. PACKAGE CONTOUR OPTIONAL WITHIN DIMENSIONS A & B. SLUGS, IF ANY, SHALL BE INCLUDED WITHIN THIS CYLINDER BUT SHALL NOT BE SUBJECT TO THE MINIMUM LIMIT OF DIM. A.
2. LEAD DIAMETER NOT CONTROLLED IN THIS ZONE TO ALLOW FOR FLASH, LEAD FINISH BUILD-UP, AND MINOR IRREGULARITIES OTHER THAN SLUGS.



Quality Semi-Conductors