

Electrical Testing
per Tusonix standard
test plans and Mil-Std-202
Test Methods.

MARKETING SALES DRAWING
DIMENSIONS IN INCHES - DO NOT SCALE THIS DRAWING
DIMENSIONS IN METRIC - []

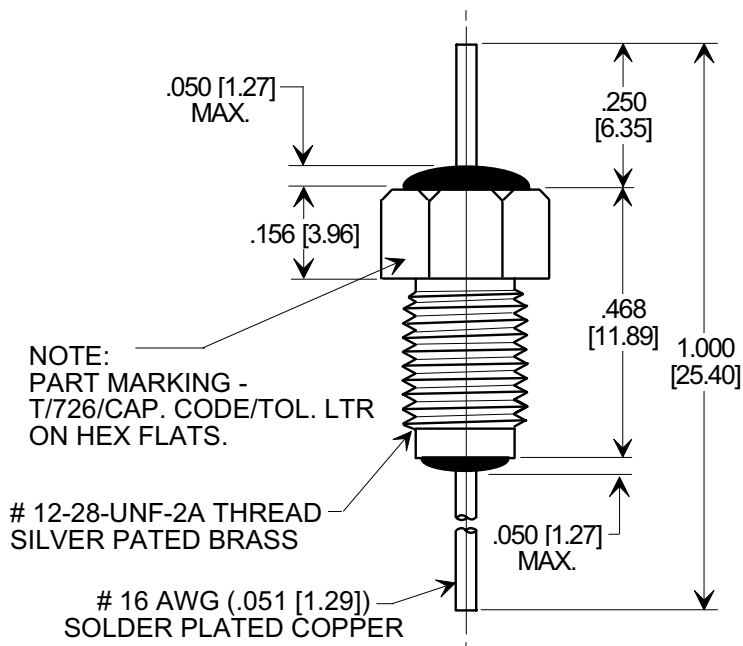
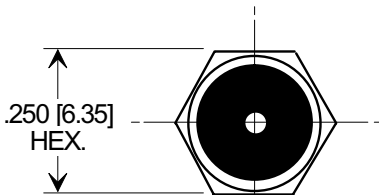
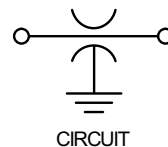
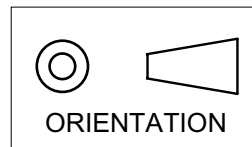

NOTE:
1. SUPPLIED WITH SILVER PLATED
HEX NUT AND INTERNAL TOOTH
LOCKWASHER.

MIL-C-39014/16 (CKR 75) PART NO.
M39014/16-0066

TUSONIX HI-RELIABILITY COMMERCIAL
REPLACEMENT PART NO.
2499-726-X5R0-680K

CAP. VALUE	68pF
CAP. TOL.	±10%
TEMP. COEF.	X5R
VOLT. RATING	500 VDC +85°C
OPERATING TEMP. RANGE	-55 TO +85°C
TESTED TO TUSONIX EQUIVALENT TO MIL-C-39014 FOR GROUP A INSPECTION INCLUDING SUMMARY TEST DATA	

X-2015 Rev-0 REVISION RECORD Original Release C.O. 20030107-6-03	0	--TOLERANCES-- Unless Otherwise Specified DECIMAL ± .031 [0.79] ANGLES ±	Title HI-RELIABILITY COMMERCIAL REPLACEMENT FOR M39014/16 (CKR75) FEED-THRU CAPACITOR		
	TUSONIX TUCSON, ARIZONA		Drawn S.M. 01-08-03	Scale 4 X	
	A		Approved B.Mc. 01-08-03		
	2499-726-X5R0-680K				