

This document is the property of Amphenol Corporation and is delivered on the express condition that is not to be disclosed, reproduced or used, in whole or in part, for manufacture or sale by anyone other than Amphenol Corporation without its prior consent, and that no right is granted to disclose or to use any information in this document.  
 The marking on this product doesn't contain environmental hazardous materials per Material Specification SS-00259 for Sony GP compliant or per directive 2002/95/EC for RoHS compliant.



ORIGINAL



REVISIONS				
SYM	ECN No.	DESCRIPTION	DATE	APPROVED
A		RELEASE TO PRODUCTION	09/09/2008	Hank Hsu
B	NE-08325	MODIFY P/N SYSTEM	09/17/2008	Hank Hsu

P/N SYSTEM:

G630E XXX X 1 X 1 X EU

NUMBER OF POSITION:

36: 36 POSITION  
 64: 64 POSITION  
 98: 98 POSITION  
 AA: 164 POSITION

TAIL LENGTH OPTION

0: 2.30mm+0.25-0.13mm  
 1: 3.10mm+0.25-0.13mm

CONTACT FINISH:

0: GOLD FLASH  
 1: 15u" GOLD  
 2: 30u" GOLD

MATERIAL OF INSULATION:

6: HIGH TEMPERATURE THERMO PLASTIC,COLOR-BLACK  
 7: HIGH TEMPERATURE THERMO PLASTIC,COLOR-WHITE

NOTES:

- MATERIAL:  
 HOUSING: HIGH TEMPERATURE THERMO PLASTIC UL94V-0  
 TERMINAL: PHOSPHOR BRONZE
- FINISH:  
 TERMINAL:  
 CONTACT AREA: SELECTIVE GOLD PL.  
 SOLDERING AREA: MATT TIN PL. 100 μ" THK MIN.  
 UNDER PL.: NICKEL PL. 50 μ" THK MIN.
- THIS PRODUCT DOESN'T CONTAIN ENVIRONMENTAL HAZARDOUS PER DIRECTIVE 2002/95/EC FOR RoHS COMPLIANT.

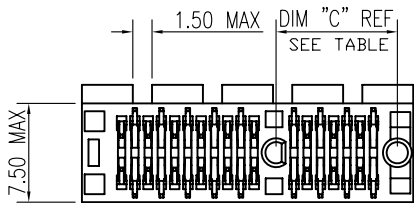
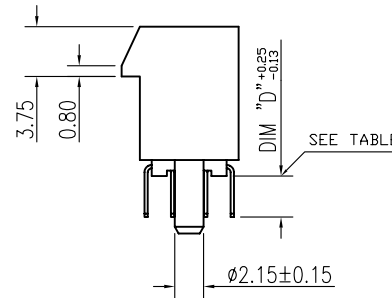
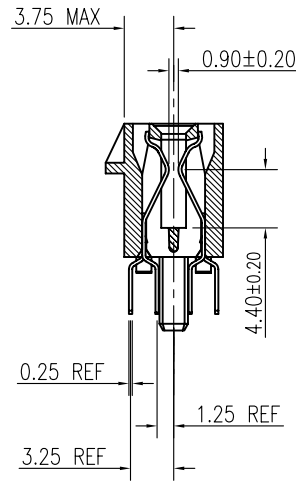
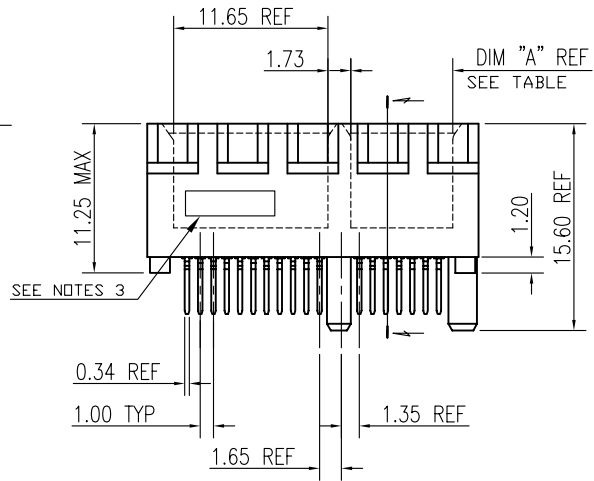
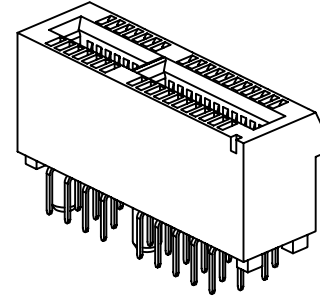
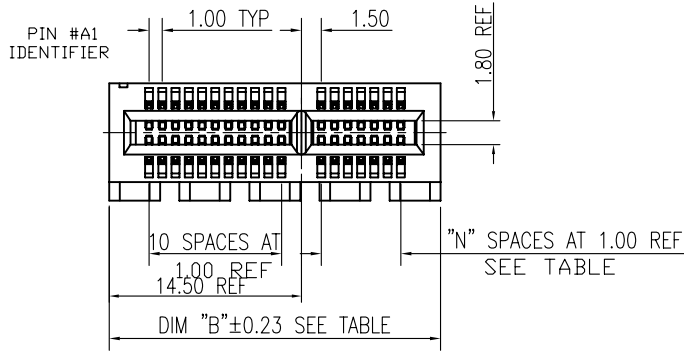

CONNECTOR LINK WIDTH	# PDS REF	N	DIM "A" REF	DIM "B" REF	DIM "C" REF	PCB THK (REF)	DIM "D" REF
X1	36	6	7.65	25.00	9.15	1.58	2.30
X4	64	20	21.65	39.00	23.15	2.36	3.00
X8	98	37	38.65	56.00	40.15		
X16	164	70	71.65	89.00	73.15		

TOLERANCE	DRAWN	APPROVALS	DATE	TITLE	UNIT	SIZE	PART No.
X. ±0.30 X.X ±0.20 X.XX ±0.20 X.XXX ±0.10	DESIGNED	Chenny Yeh	17/09/08	PCI EXPRESS EDGE CARD CONNECTOR	mm	A3	G630EXXX1X1XEU
ANGULAR ±1°	CHECKED	Sondra Sang	17/09/08				
UNLESS OTHERWISE SPECIFIED	APPROVED	Hank Hsu	17/09/08	PROJECT CODE SLOT	SCALE	SHEET	DWG No.
	DWG TYPE	Hank Hsu			NA	1 OF 4	G630EXXX1X1XAEU

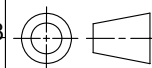

REV. B

Amphenol®  
 Amphenol Corporation  
 Amphenol Taiwan Corporation

This document is the property of Amphenol Corporation and is delivered on the express condition that is not to be disclosed, reproduced or used, in whole or in part, for manufacture or sale by anyone other than Amphenol Corporation without its prior consent, and that no right is granted to disclose or to use any information in this document.

The marking on this product doesn't contain environmental hazardous materials per Material Specification SS-00259 for Sony GP compliant or per directive 2002/95/EC for RoHS compliant.



ORIGINAL



REVISIONS				
SYM	ECN No.	DESCRIPTION	DATE	APPROVED
A		RELEASE TO PRODUCTION	09/09/2008	Hank Hsu
B	NE-08325	MODIFY P/N SYSTEM	09/17/2008	Hank Hsu

P/N SYSTEM:

G630E XXX X 1 X 1 X EU

NUMBER OF POSITION:

- 36: 36 POSITION
- 64: 64 POSITION
- 98: 98 POSITION
- AA: 164 POSITION

TAIL LENGTH OPTION

- 0: 2.30mm+0.25-0.13mm
- 1: 3.10mm+0.25-0.13mm

CONTACT FINISH:

- 0: GOLD FLASH
- 1: 15u" GOLD
- 2: 30u" GOLD

MATERIAL OF INSULATION:

- 6: HIGH TEMPERATURE THERMO PLASTIC,COLOR-BLACK
- 7: HIGH TEMPERATURE THERMO PLASTIC,COLOR-WHITE

NOTES:

1. MATERIAL:

HOUSING: HIGH TEMPERATURE THERMO PLASTIC UL94V-0  
TERMINAL: PHOSPHOR BRONZE

2. FINISH:

TERMINAL:

CONTACT AREA: SELECTIVE GOLD PL.  
SOLDERING AREA: MATT TIN PL. 100 μ" THK MIN.  
UNDER PL.: NICKEL PL. 50 μ" THK MIN.

3. THIS PRODUCT DOESN'T CONTAIN ENVIRONMENTAL HAZARDOUS PER DIRECTIVE 2002/95/EC FOR RoHS COMPLIANT.

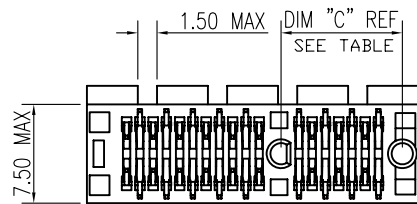
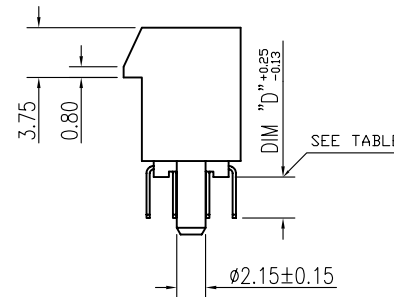
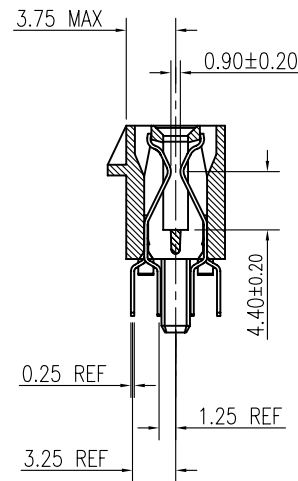
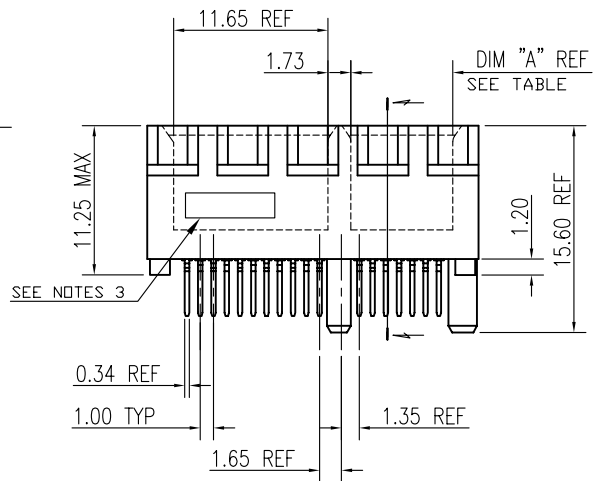
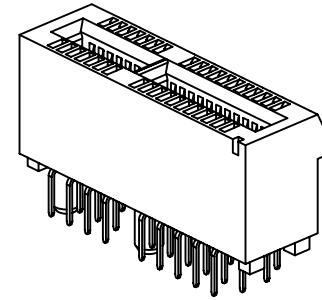
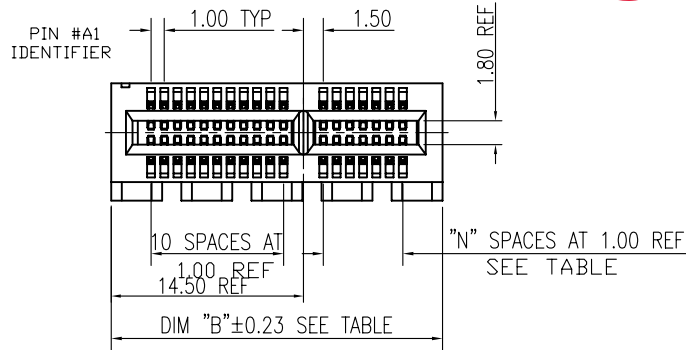

CONNECTOR LINK WIDTH	# PDS REF	N	DIM "A" REF	DIM "B" REF	DIM "C" REF	PCB THK (REF)	DIM "D" REF
X1	36	6	7.65	25.00	9.15	1.58	2.30
X4	64	20	21.65	39.00	23.15	2.36	3.00
X8	98	37	38.65	56.00	40.15		
X16	164	70	71.65	89.00	73.15		

TOLERANCE	DRAWN	APPROVALS	DATE	TITLE	UNIT	SIZE	PART No.
X. ±0.30	DESIGNED	Chenny Yeh	17/09/08	PCI EXPRESS EDGE CARD CONNECTOR	mm	A3	G630EXXX1X1XEU
X.X ±0.20	CHECKED	Sondra Sang	17/09/08				
X.XX ±0.10	APPROVED	Hank Hsu	17/09/08	PROJECT CODE SLOT	SCALE NA	SHEET 1 OF 4	DWG No. G630EXXX1X1XAEU
ANGULAR ±1°	DWG TYPE	CUST DWG					
UNLESS OTHERWISE SPECIFIED							

This document is the property of Amphenol Corporation and is delivered on the express condition that it is not to be disclosed, reproduced or used, in whole or in part, for manufacture or sale by anyone other than Amphenol Corporation without its prior consent, and that no right is granted to disclose or to use any information in this document.

The marking on this product doesn't contain environmental hazardous materials per Material Specification 55-00259 for Sony GP compliant or per directive 2002/95/EC for RoHS compliant.

ORIGINAL

REVISIONS				
SYM	ECN No.	DESCRIPTION	DATE	APPROVED
A		RELEASE TO PRODUCTION	09/09/2008	Hank Hsu
B	NE-08325	MODIFY P/N SYSTEM	09/17/2008	Hank Hsu

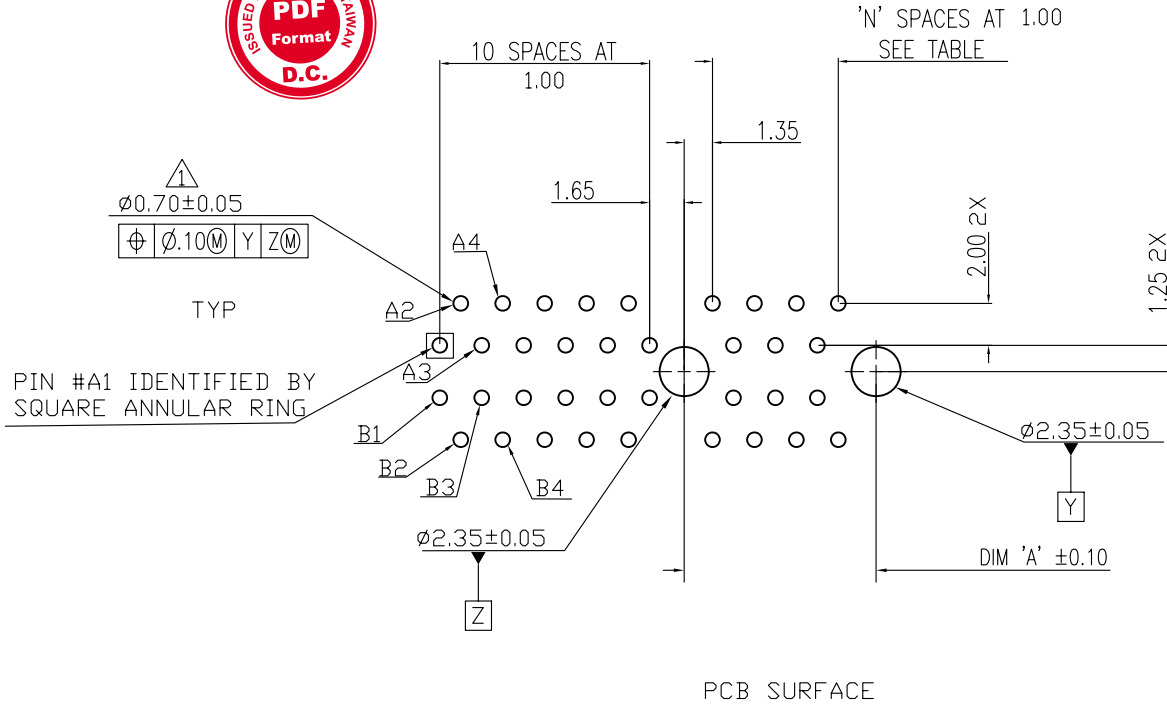

CONNECTOR LINK WIDTH	# POS REF	N	DIM 'A'
X1	36	6	9.15
X4	64	20	23.15
X8	98	37	40.15
X16	164	70	73.15

1 THE HORIZONTAL AXIS FOR THE HOLE PATTERN IS ESTABLISHED BY A LINE THROUGH THE CENTER OF THE TWO  $\phi 2.35$  HOLES. THE VERTICAL AXIS IS 90° TO THE HORIZONTAL AXIS, THROUGH THE CENTER OF DATUM  $-Z-$

TOLERANCE	DRAWN	APPROVALS	DATE	TITLE								
X. ±0.30	DESIGNED BY	Chenny Yeh	17/09/08	PCI EXPRESS EDGE CARD CONNECTOR	<b>Amphenol®</b> Amphenol Corporation Amphenol Taiwan Corporation							
X.X ±0.20	CHECKED	Sondra Sang	17/09/08									
X.XXX ±0.10	APPROVED	Hank Hsu	17/09/08		UNIT	mm	SIZE	A3	PART No.	G630EXXX1X1XEU		
ANGULAR ±1°	DWG TYPE	CUST DWG	PROJECT CODE		SLOT	SCALE	NA	SHEET	3 OF 4	DWG No.	G630EXXX1X1XAEU	REV.
UNLESS OTHERWISE SPECIFIED												

This document is the property of Amphenol Corporation and is delivered on the express condition that it is not to be disclosed, reproduced or used, in whole or in part, for manufacture or sale by anyone other than Amphenol Corporation without its prior consent, and that no right is granted to disclose or to use any information in this document.

The marking on this product doesn't contain environmental hazardous materials per Material Specification 55-00259 for Sony GP compliant or per directive 2002/95/EC for RoHS compliant.



ORIGINAL



REVISIONS				
SYM	ECN No.	DESCRIPTION	DATE	APPROVED
A		RELEASE TO PRODUCTION	09/09/2008	Hank Hsu
B	NE-08325	MODIFY P/N SYSTEM	09/17/2008	Hank Hsu

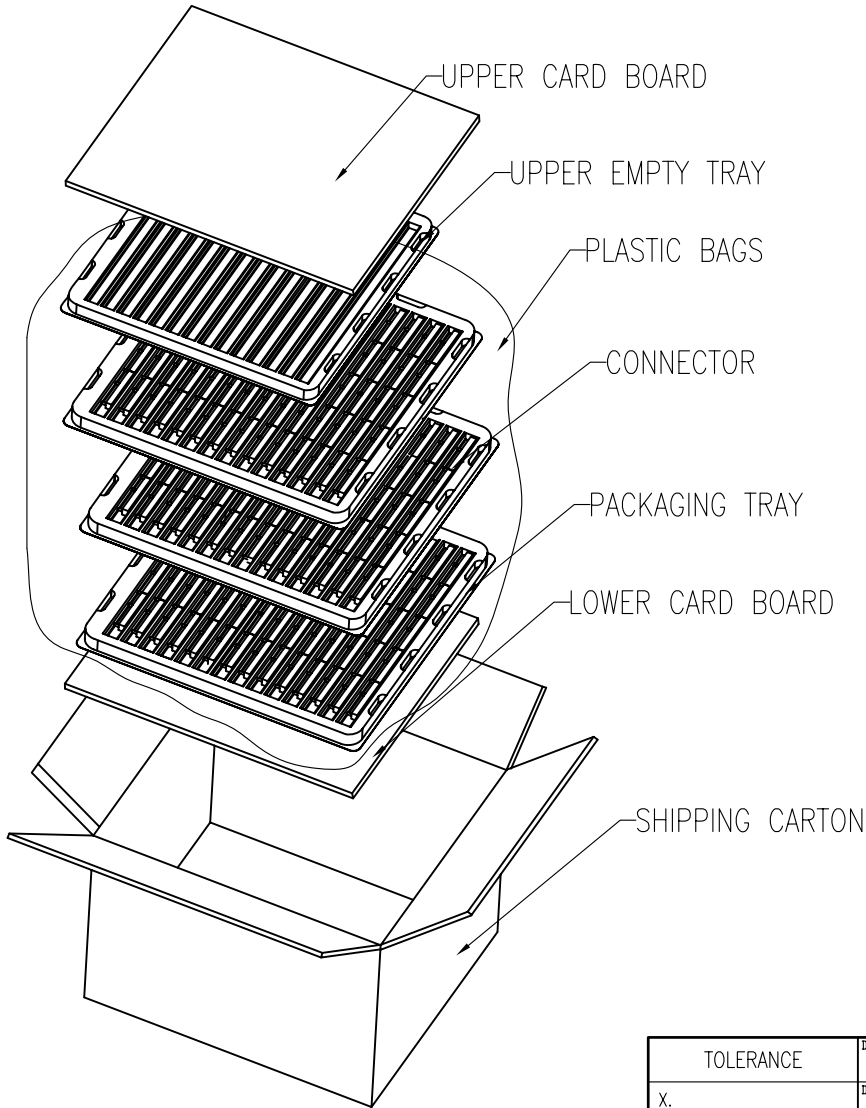

CIRCUIT SIZE	26	36	64	98	164	200	230	280
PARTS PER CARTON<S.P.Q>	3780	2730	1680	1260	630	630	420	420
PARTS PER TRAY	252	182	112	84	42	42	28	28
TOTEL TRAY PER CARTON	16	16	16	16	16	16	16	16



NOTES:

1. STAPLES SHOULD ONLY BE USED TO SET UP CARTON. ALL CARTON CLOSURES MUST BE DONE WITH TAPE.
  2. FILL PACKAGING TRAYS WITH THE QUANTITIES AS INDICATED IN THE CHART.
- 3 IN THE 16 PLASTIC TRAYS ,THE TOP PLASTIC TRAY IS TO COVER THE CONNECTORS ,THE OTHERS ARE FILLED WITH CONNECTORS.

TOLERANCE	DRAWN	APPROVALS	DATE	TITLE	G630 SERIES PACKING DRAWING		Amphenol® Amphenol Corporation Amphenol Taiwan Corporation			
X. ±0.30	DESIGNED	Chenny Yeh	17/09/08		UNIT	mm	SIZE	A3	PART No.	G630EXXXXXXEU
X.X ±0.20	CHECKED	Sondra Sang	17/09/08		SCALE	NA	SHEET	4 OF 4	DWG No.	G630EXXXXXXEU
X.XXX ±0.10	APPROVED	Hank Hsu	17/09/08		REV.	B				
ANGULAR ±1°	DWG TYPE	CUST DWG	PROJECT CODE	SLOT						
UNLESS OTHERWISE SPECIFIED										