

# IURC4251

Page 1 of 2

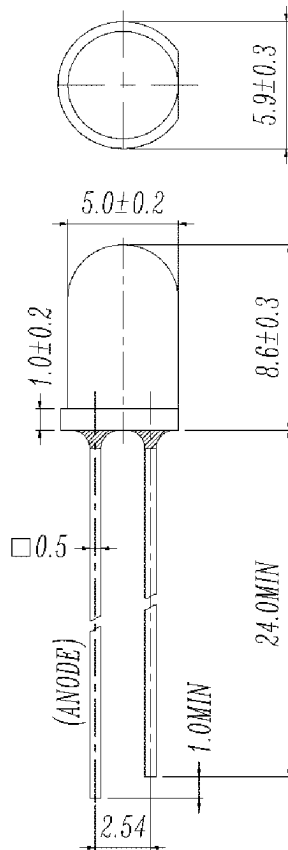

This lamp is a T-1 3/4, 5 mm Round.



RoHS Compliant  
Aug 2004

PART NO.	Chip		Lens Color
	Material	Emitted Color	
IURC4251	GaAlAs	Super Red	Water Clear

\* Specifications subject to change without notice. Dimensions are in mm±0.25 unless stated otherwise.

**Absolute Maximum Ratings at  $T_a = 25\text{ }^\circ\text{C}$** 

Parameter	Symbol	Rating	Units
Forward Current	$I_F$	40	mA
Operating Temperature	$T_{opr}$	-40 to +85	$^\circ\text{C}$
Storage Temperature	$T_{stg}$	-40 to +100	$^\circ\text{C}$
Soldering Temperature	$T_{sol}$	$260 \pm 5$	$^\circ\text{C}$
Power Dissipation	$P_d$	110	mW
Pulse Forward Current (Duty 1/10 at 1 KHz)	$I_F$ (Peak)	180	mA
Reverse Voltage	$V_R$	5	V

**Electronic Optical Characteristics**

Parameter	Symbol	Min.	Typ.	Max.	Units	Condition	
Luminous Intensity	$I_v$	IURC4251	630	1200	—	mcd	$I_F = 20\text{ mA}$
		IURC4251-2	1000	—	3200		
		IURC4251-3	1600	3000	—		
Viewing Angle	$2\theta_{1/2}$	—	10	—	deg	$I_F = 20\text{ mA}$	
Peak Wavelength	$\lambda_p$	—	660	—	nm	$I_F = 20\text{ mA}$	
Dominant Wavelength	$\lambda_d$	—	643	—	nm	$I_F = 20\text{ mA}$	
Spectrum Radiation Bandwidth	$\Delta\lambda$	—	20	—	nm	$I_F = 20\text{ mA}$	
Forward Voltage	$V_F$	1.5	1.7	2.4	V	$I_F = 20\text{ mA}$	
Reverse Current	$I_R$	—	—	10	$\mu\text{A}$	$V_R = 5\text{ V}$	

\* Specifications subject to change without notice. Dimensions are in mm $\pm$ 0.25 unless stated otherwise.

IDEA, Inc., 1351 Titan Way, Brea, CA 92821 Ph:714-525-3302, 800-LED-IDEA; Fax: 714-525-3304 0507