

NOTES: UNLESS OTHERWISE SPECIFIED

1. FOR GENERAL SERIES SPECIFICATIONS, SEE SD25-0000 (SMA) & SD36-0000 (BMA).

2. MATERIAL SPECIFICATIONS:

BODY: STAINLESS STEEL PER ASTM A582  
 INSULATOR: PTFE PER ASTM D1710  
 CONTACT: COPPER ALLOY  
 LOCKWASHER: PHOSPHOR BRONZE PER ASTM B103  
 NUT: BRASS PER ASTM B16

3. FINISH SPECIFICATIONS:

BODY: PASSIVATION PER ASTM A967  
 CONTACT: .000030 MIN GOLD PER ASTM B4888 OVER  
 .000080 MIN NICKEL PER AMS-QQ-N-290  
 LOCKWASHER & NUT: .000100 MIN NICKEL PER AMS-QQ-N-290 OVER  
 COPPER FLASH PER ASTM B734

4. ELECTRICAL SPECIFICATIONS:

FREQUENCY RANGE: DC TO 18 GHz  
 VSWR: 1.15 MAX DC TO 18 GHz

5. NUT, LOCKWASHER AND O-RING SHIPPED LOOSE.

REV	DESCRIPTION	BY DATE	APPD
A	RELEASE EWR07-ERS329	DCam 6/6/08	WPM

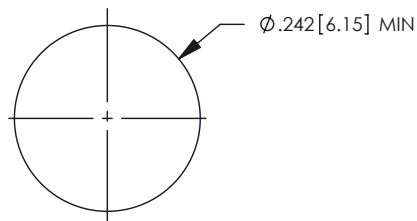
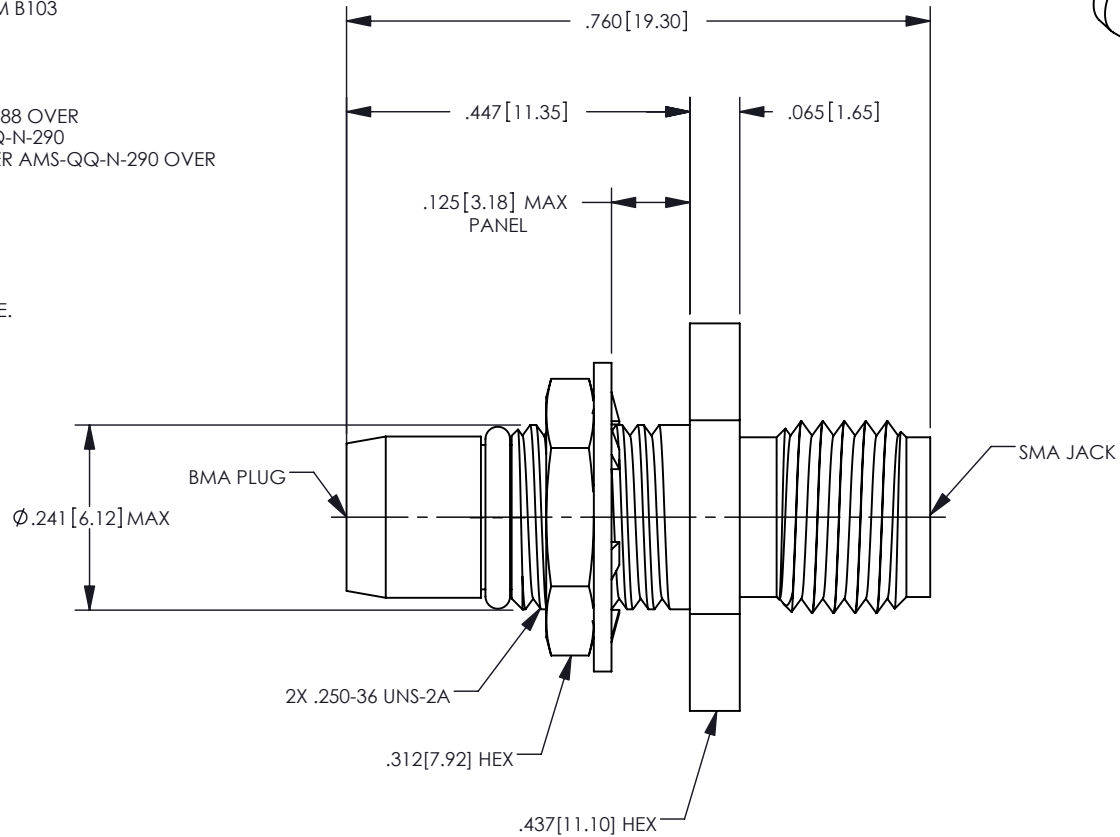
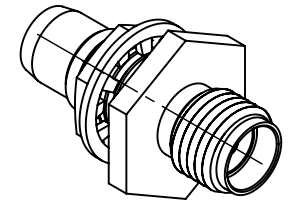

RECOMMENDED MOUNTING HOLE

CATALOG P/N: 251-360-0001P

PER ASME Y14.5M-1994 UNLESS OTHERWISE SPECIFIED: DIMENSIONS ARE IN INCHES [MM] TOLERANCES: DECIMAL: .XX [X.X] ± .01 [0.3] .XXX [X.XX] ± .005 [0.13] .XXXX [X.XXX] ± .XXXX ANGLES: ± 2° SCALE: 4:1				Winchester Electronics Corporation 62 Barnes Industrial Road North Wallingford, Connecticut 06492	
CUSTOMER DRAWING					
DRAWN DCam	DATE 11/21/07	APPROVED M.AYUB	DATE 11/26/07	SMA JACK TO BMA BULKHEAD PLUG ADAPTER	
APPROVED J.CAV	DATE 11/26/07	APPROVED WPM	DATE 2/27/08	<b>A</b>	SD251-360-0001P SHT 1 OF 1 REV A