

NOTES:

1. DELETED.
- 2 SCREW AND WASHER TO BE SHIPPED UNASSEMBLED IN A SEPARATE BAG.
- 3 ALL TORQUE TESTING MUST BE PERFORMED WITH A .038 / 0.97 MINIMUM THICK SPACER BETWEEN THE SCREW HEAD AND TERMINAL BODY.
- 4 TORQUE REQUIREMENTS: THE THREADS OF THE POWER TERMINAL AND THE BRASS SCREW SUPPLIED WILL WITHSTAND 8 IN.-LBS. MINIMUM OF TIGHTENING TORQUE WITHOUT DAMAGE. WHEN A WASHER WITH A MINIMUM THICKNESS OF .038 / 0.97 (AS SUPPLIED) IS INSTALLED BETWEEN THE SCREW HEAD AND THE POWER TERMINAL BODY.
- 5 NO PLATING ON EDGES SHOWN.
- 6 C-Press® CONTACT PLATED THRU HOLE REQUIREMENTS PER DRAWING 27331.

SPECIFICATIONS

MATERIALS

Power Terminal ————— Copper-Nickel-Tin Alloy, CDA 72500
Finish: SEE CHART 5

2 3 Screw (Not Shown) ————— Brass (SEE CHART)

2 3 Washer (Not Shown) ————— Brass, Cad Plated
(.21 / 5.3 Min. O.D. X .038 / 0.97 Min. Thk.)

PERFORMANCE CHARACTERISTICS

Current rating, 10 Pin ————— 36 amp. @ 30°C rise

Operating temperature range ————— -55°C to +105°C

C-Press® Performance:

- Maximum insertion force, 10 Pin ————— 400 lbs. max.
- Minimum retention force, 10 Pin ————— 80 lbs. min.
- Number of repair cycles without hole deformation or performance loss ————— 3
- Contact to PTH electrical resistance — 2 milliohms max.

REV	DESCRIPTION	BY DATE	APPD
L	REVISED PER ECR-ER1962	C.M.B. 11/30/06	C.M.B.

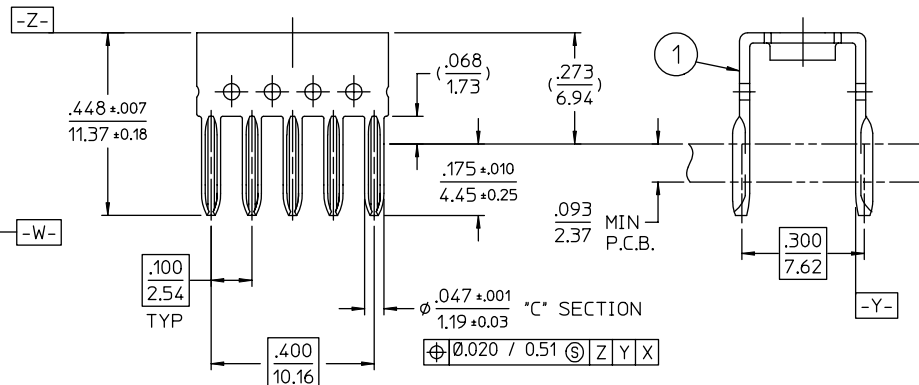
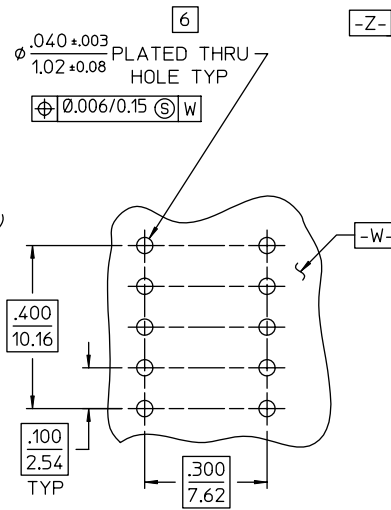
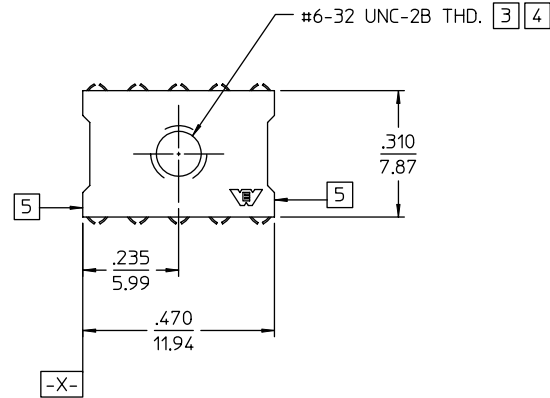

P.C. BOARD HOLE PATTERN

121-27239-1 SHOWN

121-27239-03	WITH #6-32 UNC-2A SCREW AND NICKEL PLATED BRASS WASHER	107-42253 (DRACON)			TIN LEAD (RoHS)
121-27239-02-260	SAME AS 121-27239 EXCEPT ø.188 THRU HOLE INSTEAD OF #6-32 TAPPED HOLE	107-42252 (PRESS)			PURE TIN (LEAD FREE RoHS)
121-27239-02					TIN LEAD
121-27239-1	WITH #6-32 UNC-2A SCREW AND CAD PLATED BRASS WASHER	107-42253 (DRACON)	107-42504	107-42055 (DRACON)	TIN LEAD
121-27239-00-260	WITHOUT #6-32 UNC-2A SCREW AND WASHER				PURE TIN (LEAD FREE RoHS)
121-27239					TIN LEAD
CATALOG NO	DESCRIPTION	INSERTION TOOL	REMOVAL TOOL	IMPACT HANDLE	PLATING

121 SERIES

UNLESS OTHERWISE SPECIFIED: DIMENSIONS ARE IN INCHES. OR INCHES / MM

TOLERANCES
DECIMALS .xx ±.02 / 0.5
xxx ±.005 / 0.13
ANGLES ± SCALE: 4:1

CUSTOMER DRAWING

DATE CHECKED DATE
LNB 12/05/83 JAD 12/08/83

DATE APPROVED DATE APPROVED DATE
JAD 12/09/83

TITLE
POWER TERMINAL
.100 X .300 GRID - 10 PIN

62 Barnes Industrial Road North
Wallingford, Connecticut 06492

C 27239 SHT. 1 OF 1 REV. L

June 2006 - This drawing became the property of Winchester Electronics Corporation, Wallingford, CT.