

molex® RJ-45 Field Wireable Ethernet Connectors

Features and Benefits

- Meets Open Device Vendors' Association and ControlNet Vendors' Association IP Specifications
- IP 67 NEMA 6P Rating
- One piece molded plug is more robust than competition
- One Sealing Surface means less likelihood of failure
- Easy termination allows custom length cable to be made in field



Specifications

Reference Information:

Packaging: Bag
 Minimum Order Qty.: 5
 Standard Pack Size: 1

Environmental:

Temperature Rating: -40 to +85°C
 Waterproof: Meets requirements of NEMA 6P and IP67 for water tightness
 UL RTI Electrical: 130°C at 0.03"
 UL RTI Mechanical Without Impact: 140°C at 0.03"

Electrical:

Type: Category 5E
 Transmission Performance: Category 5
 RJ-45 Connection Interface: TIA/EIA-568-B
 Voltage: 150V
 Current Rating: 1.5A
 Shielding Effectiveness: 20dB min.
 Contact Resistance: 20 milliohms max.
 Insulation Resistance: 500 Megohms min.

Mechanical:

Durability: 500 cycles min.

Physical:

Tether-Dust Cap: PP or PA
 Nut-Jam/Lock: Zinc/Steel
 Gaskets: Panel – Neoprene
 O-ring – Nitrile
 Assemblies: Strain Relief/Cable Seal – PA, TPE Gland
 Plug Holde, Receptacle, Dust Cap, Locking Ring
 Wedge – PBTP
 Screw-Dust Cap: Zinc/Steel

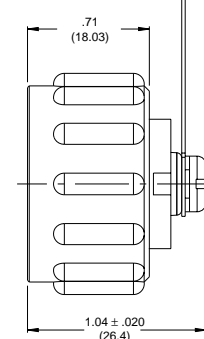
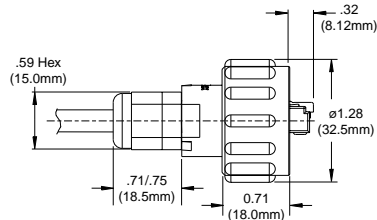
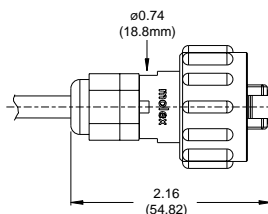
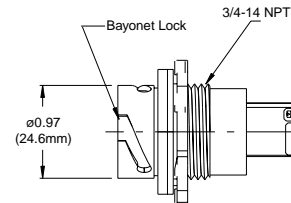
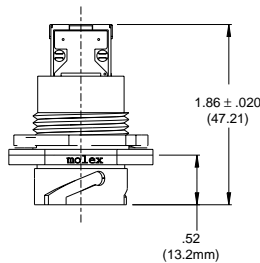
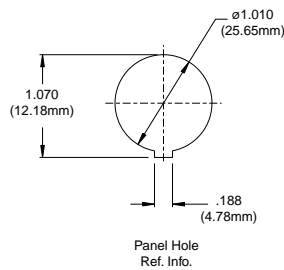

Features and Benefits

84700-0001 Field attachable plug

- Robust bayonet style lock
- Only one sealing surface provides a low likelihood of failure
- Superior strain relief
- Meets NEMA 6P and IP 67 rating
- Easy plug termination

84700-0002 Receptacle

- Simple error free mating
- Keyed receptacle housing allows easy damage-free mating

84700-0003 Receptacle

- Same design as plug maintains all of its features

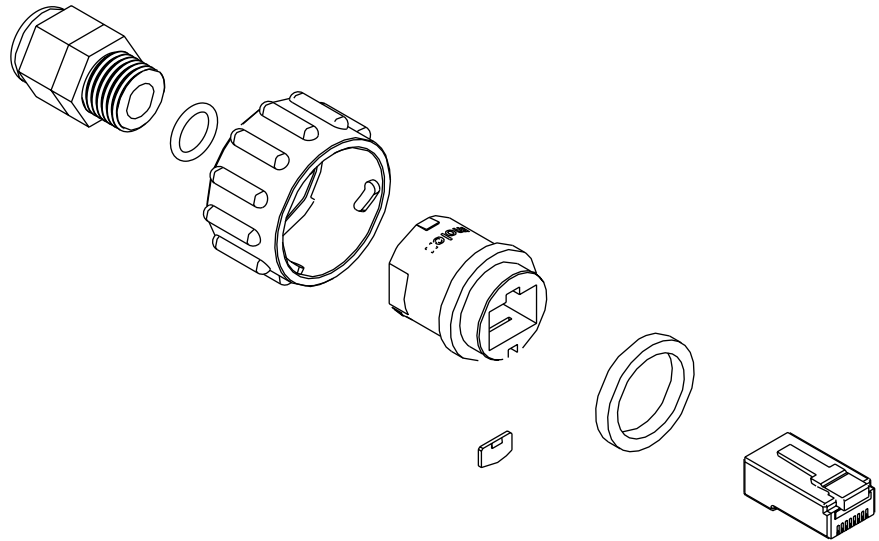

ORDERING INFORMATION

Order No.	Description
84700-0001	Receptacle
84700-0002	Field Wireable Plug
84700-0003	Dust Cap

APPLICATIONS

- Industrial Environment
 - Food and Beverage
 - Automotive
 - Chemical
 - Other continuous and batch processes
- Water Treatment plants
 - Waste water
 - Municipal drinking water
- Transportation Hubs
 - Airports
 - Bus Stations
 - Rail Stations

Industrial Headquarters

4650 62nd Ave. N.
Pinellas Park, FL 33781
727-521-2700
amerinfo@molex.com

Far East North Headquarters

Yamato, Kanagawa, Japan
81-462-65-2324
feninfo@molex.com

Far East South Headquarters

Jurong, Singapore
65-6-268-6868
fesinfo@molex.com

European Headquarters

Munich, Germany
49-89-413092-0
eurinfo@molex.com

Corporate Headquarters

2222 Wellington Ct.
Lisle, IL 60532 U.S.A.
630-969-4550
Fax:630-969-1352

Visit our Web site at <http://www.molex.com>