

Recommended P.C.B Layout

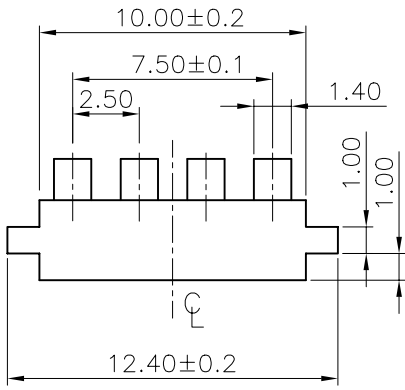
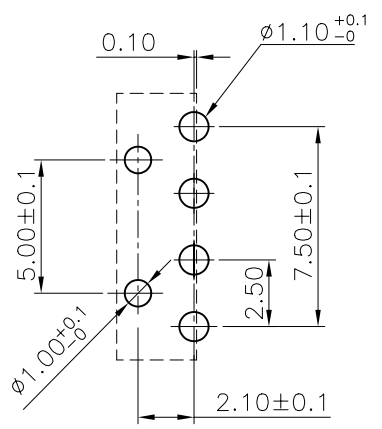
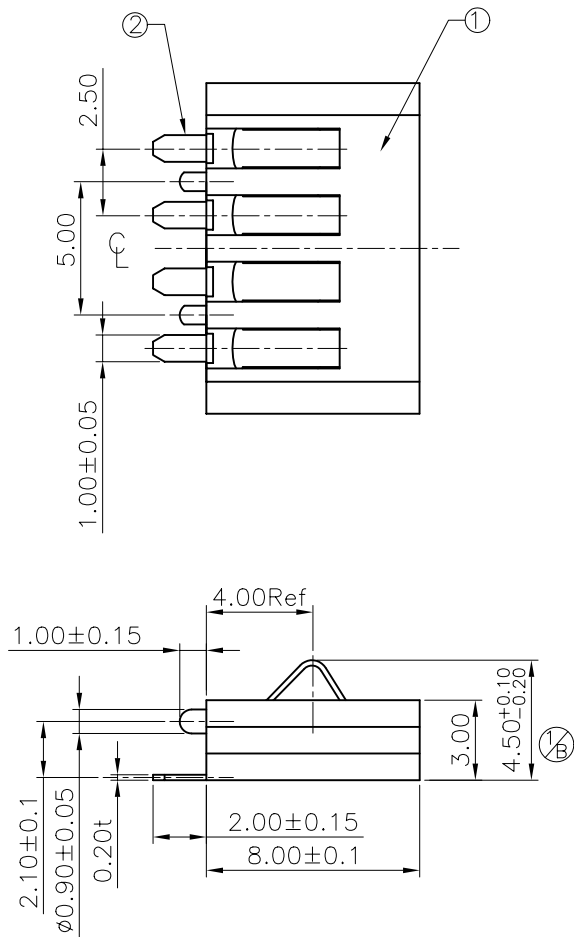

NOTE(I):
 250105MR□□□□05ZU
 1 2

- 1. No. of pins.
- 2. Selective plating
- 'G1,-05u" gold over nickel.
- 'G2,-Indicate gold flash.
- 'G3,-10u" gold over nickel.
- 'G4,-15u" gold over nickel.
- 'G5,-30u" gold over nickel.
- 'S1,-05u" Min. gold in contact area/
100u" Min. Tin in solder area.
- 'S2,-Gold flash in contact area/
100u" Min. Tin in solder area.
- 'S3,-10u" Min. gold in contact area/
100u" Min. Tin in solder area.
- 'S4,-15u" Min. gold in contact area/
100u" Min. Tin in solder area.
- 'S5,-30u" Min. gold in contact area/
100u" Min. Tin in solder area.
- 'S6,-50u" Min. gold in contact area/
100u" Min. Tin in solder area.

NOTE 1:
 Material Specifications :
 1. Plastic Housing : NY-6T UL94V-0 Black Color
 2. Terminal : Pho. Bronze 5210
 Pating:
 1. Signal Pin :
 Contact Area : 15u" Gold Plating
 Solder Area : 100u"(Min.) Tin Plating
 2. Power Pin : 100u"(Min.) Tin Plating

2	Terminal	Phos.Bronze	—	Gold Plated
1	Plastic	NY-6T	BLACK	UL94V-0
NO.	DESCRIPTION	MATERIAL	COLOR	REMARK

SUYIN
CONNECTOR

CUSTOMER COPY TITLE:2.50mm Pitch Battery Conn

EC1T-020506-03	C	02/05/06	C1:增加新料號	黃能貴	李儒平	Angle 30 ~ 30	±2'	DRAW	周孫宇	01/10/23	PART NO.	250105MR004XX05ZU (1/A)				
EC1T-011206-05	A	01/12/06	B1:4.60→4.50 ^{+0.10} / _{-0.20} A1:ADD→GXT電鍍規格	王淑麗	宋權哲	10 ~ 10	±0.30	DESIGN	周孫宇	01/10/23	PART NO. (OLD)	2505A-04GXX-E				
	O	01/11/01	NEW			~ 10	±0.15	CHECK	陳清照	01/10/23	DRAWING NO.	250105MR004XX05ZU				
ECN (DCN) NO.	REV	DATE	DESCRIPTION	CHANGE	APPRO.	GENERAL TOLERANCE UNLESS OTHERWISE NOTED		APPRO.	宋權哲	01/10/23	SCALE	4:1	UNIT	mm	A4	(1/A)