

1N816

PARAMETERS

Description: Forward Reference Diode

Manufacturer.....	many
Mil/High-Rel? (Y/N).....	
If Max (A).....	
1-Cycle Surge Current (A).....	
Vf Max.....	739m
@If (test).....	1.0m
Ir @25xC.....	10u
@Volts (test) (V).....	10
Mat.....	Silicon
Pkg Style.....	DO-35
Surface Mounted (Y/N).....	N

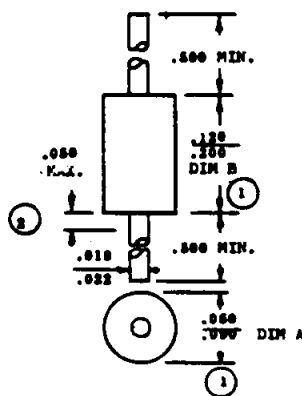

1. PACKAGE CONTOUR OPTIONAL WITHIN DIMENSIONS A & B. SLUGS, IF ANY, SHALL BE INCLUDED WITHIN THIS CYLINDER BUT SHALL NOT BE SUBJECT TO THE MINIMUM LIMIT OF DIM. A.
2. LEAD DIAMETER NOT CONTROLLED IN THIS ZONE TO ALLOW FOR FLASH, LEAD FINISH BUILD-UP, AND MINOR IRREGULARITIES OTHER THAN SLUGS.

