

■Package Side Terminals

●Optical Terminals (Jack)

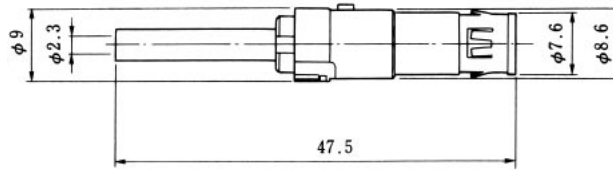

HRS No.	Product Number	Suitable Fiber	Suitable Cable	Split Sleeve Specification
CL707-0007-1	HRPI-BJH2	SM-9.5/125, GI-50/125	ø2mm	Copper alloy
CL707-0016-2	HRPI-BJH2-D	SM-9.5/125, GI-50/125	ø2mm	Zirconia

●Optical Terminals for Cable (Jack)

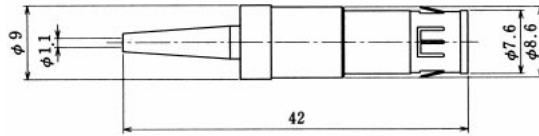

HRS No.	Product Number	Suitable Fiber	Suitable Cable	Split Sleeve Specification
CL707-0042-2	HRPI-BJH1	SM-9.5/125, GI-50/125	ø0.9mm	Copper alloy
CL707-0029-4	HRPI-BJH1-D	SM-9.5/125, GI-50/125	ø0.9mm	Zirconia

■Ferrules

●Multimode (2-Groove Type)

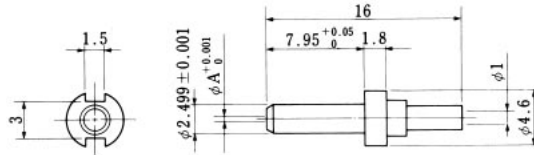

HRS No.	Product Number	Dimension A	Suitable Optical Fiber	Fiber Entrance Angle
CL704-0103-6	HSC-F321-B124	0.124	GI-50/125	60°
CL704-0104-9	HSC-F321-B125	0.125		
CL704-0105-1	HSC-F321-B126	0.126		
CL704-0106-4	HSC-F321-B127	0.127		
CL704-0107-7	HSC-F321-B128	0.128		

●Single Mode (4-Groove Type)

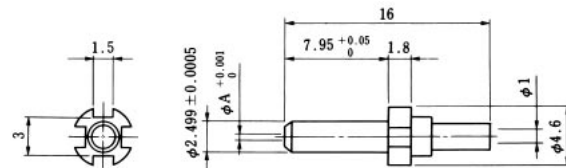

HRS No.	Product Number	Dimension A	Suitable Optical Fiber	Fiber Entrance Angle
CL704-0068-7	HSC-F321-A123	0.123	SM-9.5/125	60°
CL704-0069-0	HSC-F321-A124	0.124		
CL704-0070-9	HSC-F321-A125	0.125		
CL704-0071-1	HSC-F321-A126	0.126		
CL704-0072-4	HSC-F321-A127	0.127		
CL704-0073-7	HSC-F321-A128	0.128		

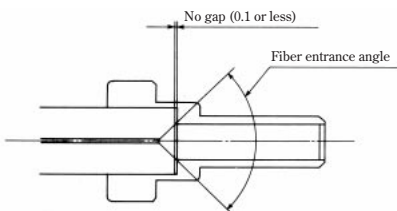

The ferrules are designed without a gap at the push-on portion to reduce disconnections at the time of wiring. The entrance angle of the fiber has been set at 60° to improve the entrance of the fiber. The single mode type has 4 grooves. This offers easier adjustment of the offset direction at time of wiring. (See diagram)