

MIL-C-38999 Series II JT Series Bayonet Coupled Crimp Circular Connectors

Features

- Lightweight Space-saving design
- Durability – 500 cycles
- EMI Shielded Optional

Customer Options

Shell sizes	– 9
Contact arrangements	– 100+
Circuit sizes	– 1 to 128

Specifications

Operating Temperature	– -55°C up to 200°C
<u>Current Rating</u>	
Contact Size 20	– 7.5A
Contact Size 16	– 13A
<u>Voltage Rating (sea level)</u>	
Service Rating I	– 600VAC(rms)
Service Rating II	– 900VAC(rms)

Tooling

Crimp Tool	– M22520/1-01
Positioner	– M22520/1-04
Insert/Remove*	– M81969/14-03**
Insert/Remove*	– M81969/14-10***

* Plastic Tool ** For Size 16 Contacts. *** For Size 20 Contacts

Related Information

Detailed catalogue – 12-090-14
Solder, PCB, Wire Wrap, Coax, Fiber & Filter optional

Part Number System: (refer to Part Number Make-up for assistance – opposite)

JT XX XX-XX-X X X (X)

CONNECTOR TYPE

JT: Standard Mil-C-38999 II
JTS: High Temperature
JTN: Chemical & Fuel Resistant

SHELL STYLE

00: Wall Mount Receptacle
01: Line Receptacle
02: Box Mount Receptacle
06: Straight Plug
07: Jam-Nut Receptacle
08: 90° Plug (AAO)
I: Solder Mount Rec. (Hermetic only)

SERVICE CLASS

RP: Potting Boot + Grommet
RE: Environmental Sealed Can add SR
RT: Environmental w/o rear Accessory
Y: Hermetically Sealed
A: Fixed Solder Contacts (LTD only)

For Cadmium-free Zinc Cobalt plating consult representative SR = Strain Relief

DEVIATIONS

Finish	Suffix	W/SR Suffix
Cadmium Plated Ni Base		(SR)
Olive Drab Cadmium Plated, Ni Base	(014)	(386)
Electroless Ni	(023)	(424)
Anodic Coating (Alumilite)	(005)	(300)
Chromate treated (Iridite 14-2)	(011)	(344)

ALTERNATE KEYING

Blank: Normal Position
See detailed catalogue for variations

CONTACT STYLE

P: Pins
S: Sockets

INSERT ARRANGEMENTS

See Insert Arrangement Table (page D-12 and D-13)

SHELL SIZE

See Insert Arrangement Table (page D-12 and D-13)

Part Number Make-up

JT00...
JTS00...
JTN00...

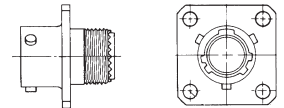

Wall Mount Receptacle

Part Number Make-up

JT01...
JTS01...
JTN01...



Line Receptacle

Part Number Make-up

JT02RE...
JTS02RE...
JTN02RE...
Cannot add SR

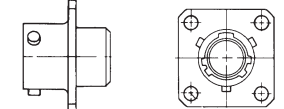

Box Mount Receptacle

Part Number Make-up

JT07...
JTS07...
JTN07...

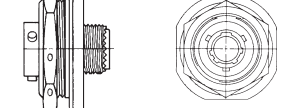

Jam Nut Receptacle

Part Number Make-up

JT06...
JTS06...
JTN06...

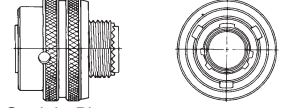

Straight Plug

JT Accessories – Cable Clamp for Crimp type Housing (if ordered separately to connector)

Part Number System:	Finish (-XX9 standard)	Diagram
10-405982-XXX SHELL SIZE 8/10/12/14/16/18/20/22/24 FINISH See adjacent table	Chromate Treat	-XX0
	Anodic Coating	-XX5
	Cadmium Plated Nickel Base	-XX7
	Olive Drab, Cadmium, Nickel Base	-XX9
	Electroless Nickel	-XXG

JT Accessories – Heat Shrinkable Backshells (shielded)

Part Number:	Shell Size	Finish	Type	Backshell Configuration (-X)			Diagram
				-1	-2	-3	
ABK A-WAR-X	8	Olive Drab Cadmium	Shielded	Straight	45°	Right Angle	
ABK A-WBR-X	10						
ABK A-WCR-X	12						
ABK A-WDR-X	14						
ABK A-WER-X	16						
ABK A-WFR-X	18						
ABK A-WGR-X	20						
ABK A-WHR-X	22						
ABK A-WJR-X	24						

Alternatives: Unshielded Replace R with U, Electroless Nickel replace W with F.

JT Accessories - Caps

Shell Size	Part Numbers:			
	Cap & Chain for Plugs Cadmium Plate, Ni Base	Chain length	Cap & Chain for Receptacle Cadmium Plate, Ni Base	Chain length
8	10-241801-089	76.2mm	10-241800-089	76.2mm
10	10-241801-109		10-241800-109	
12	10-241801-129		10-241800-129	
14	10-241801-149	88.9mm	10-241800-149	88.9mm
16	10-241801-169		10-241800-169	
18	10-241801-189		10-241800-189	
20	10-241801-209	101.6mm	10-241800-209	101.6mm
22	10-241801-229		10-241800-229	
24	10-241801-249		10-241800-249	

Diagram

Alternate Cap finishes (Replace last digit): 0=Chromate, 5=Anodic, G=Electroless Ni
Connectors individually packaged with crimp contacts (bulk contacts available) and insert/extract tool.
ASF/LTD/AAO

MS Part Numbering System

MS27467 T-11B-35 S A

Style See Chart	Alternate Keyway Letters A to D
Class *T= Threaded accessory E= With grommet nut	Contact Style P= Pin contact S= Socket contact A= Less pin contact B= Less socket contact
Shell Size Series 1 Odd nos 9 to 25 Series 2 Even Nos 8 to 24	Insert arrangement
Finish A= Clear Chromate B= Olive drab F= Electroless nickel	

* Not available in box mount receptacle style

Style Chart Series 2

Style	JT	Pan	BS series 2	MS series 2	HE309
Wall mount receptacle	00	-	C2022	27472	
Back wall mount receptacle	P000	B	C2023	27497	03
Box mount receptacle	02	-	C2251	27499	
Long box mount receptacle	02 (053)	-	C2552	27513	
Jam nut	07	A	C2024	27474	07
Back box receptacle	P02	E	C2253	27508	
Plug	06	F	C2020	27473	06
Grounded plug	G06	FG	C2021	27484	G06

Contacts Variations:

See page D-13 for a list of PINS, SOCKETS, COAX and POWER contacts available

