

# Magnetic Transducer (AC)

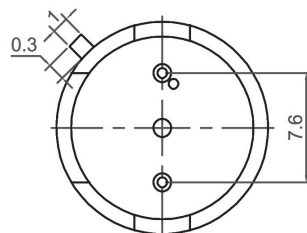

**CMT1405**

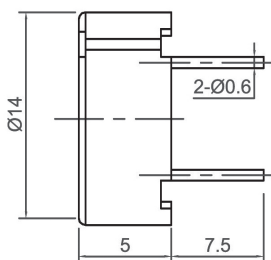
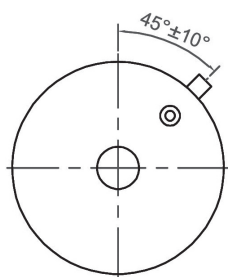
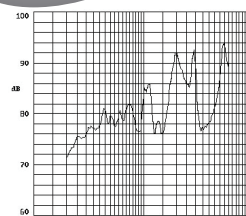

Canopus Part no.	Operating Voltage (V)	Rated Voltage (V)	Max Rated Current (mA)	Coil Resistance ( $\Omega$ )	Min Sound Output (dBA)	Resonant Frequency (Hz)	Operating Temperature ( $^{\circ}$ C)	Housing	Weight (g)
CMT1405C2000NP	1 ~ 4	3	35	15 $\pm$ 6	85 at 10cm	2000	-20 ~ +60	Noryl	2

**CANOPUS**



**CMT1612**

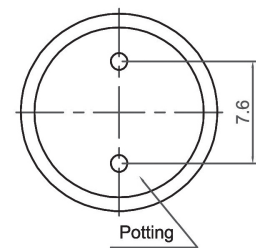
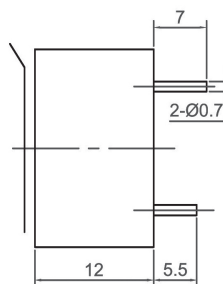
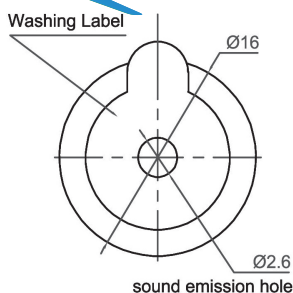
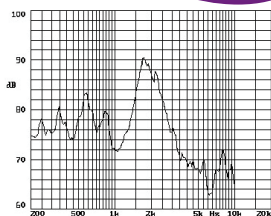

Canopus Part no.	Operating Voltage (V)	Rated Voltage (V)	Max Rated Current (mA)	Coil Resistance ( $\Omega$ )	Min Sound Output (dBA)	Resonant Frequency (Hz)	Operating Temperature ( $^{\circ}$ C)	Housing	Weight (g)
CMT1612E2048NP	3 ~ 12	5	55	28 $\pm$ 3	85 at 10cm	2048	-20 ~ +70	Noryl	2
CMT1612H2048NP	6 ~ 18	12	50	135 $\pm$ 20	85 at 10cm	2048	-40 ~ +90	Noryl	2

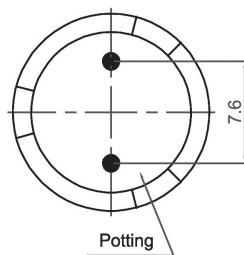
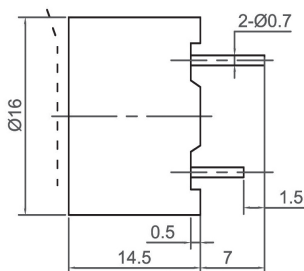
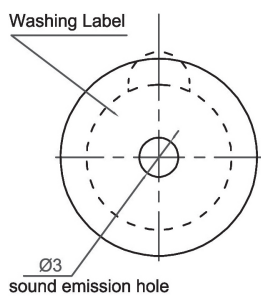

**CMT1614**

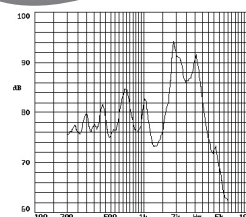

Canopus Part no.	Operating Voltage (V)	Rated Voltage (V)	Max Rated Current (mA)	Coil Resistance ( $\Omega$ )	Min Sound Output (dBA)	Resonant Frequency (Hz)	Operating Temperature ( $^{\circ}$ C)	Housing	Weight (g)
CMT1614F2048NP	3 ~ 12	6	40	45 $\pm$ 7	85 at 10cm	2048	-20 ~ +60	Noryl	7
CMT1614H2048NP	6 ~ 18	12	40	115 $\pm$ 17	85 at 10cm	2048	-30 ~ +80	Noryl	7

**Your Efficient Supplier**  
[www.canopus.com.hk](http://www.canopus.com.hk)

TEL.: (852) 2806 2812

Fax: (852) 2652 2216