

TECHNICAL DATA
DATA SHEET 1110, REV. -

DC-DC Converters

Wide Input (2:1), Non- Isolated, Regulated, Single Output

FEATURES:

- Case Temperature Rise: Max. 25° C, Typ. 15° C
- Cooling Method: Free-Air Cooling
- Operating Temp.: -20° C ~ +70° C
- Storage Temp.: -40° C ~ +85° C
- Humidity: \pm 95%
- Soldering Temp. (1): 300° C
- Case Material: Non-Flammable Material (UL94-V0)
- Mean Time Before Failure: > 200,000 hours (Operating Temp. 25° C)

P-2/3/5W Single Output Series Input Characteristics

Part Number	Nominal Input Voltage	Input Voltage Range	Maximum Input Voltage*
P07XXHD2/3/5	7.2Vdc	6.4~8.4Vdc	10Vdc
P12XXHD2/3/5	12Vdc	9~18Vdc	25Vdc
P24XXHD2/3/5	24Vdc	18~35Vdc	35Vdc
P36XXHD2	36Vdc	24~48Vdc	55Vdc

* Voltage above this value may cause permanent damage to the device.

P-2/3/5W Single Output Series Output Characteristics

Parameter	MIN	TYP	MAX	Units
Output Power			5	W
Power Consumption		2	5	mA
Line Regulation			\pm 0.3	%
Load Regulation			\pm 0.5	%
Output Voltage Accuracy			\pm 3	%
Efficiency at 100% Load	75	85	93	%
Temperature Coefficient			\pm 0.03	%/°C
Ripple and Noise		100	200	mVp-p
Switching Frequency	100		400	kHz

All specifications at TA=25°C, 75% of the humidity, Nominal input voltage, full output load unless otherwise specified.

1. Soldering for 10 seconds at 1.5mm away from the edge.

TECHNICAL DATA
DATA SHEET 1110, REV. -

P-2/3/5W Single Output Series Part Number List

Input	Power	DIP-2W	DIP-3W	DIP-5W
7.2Vdc	2W 3W 5W	P0705HD2 (400mA)	P0705HD3 (600mA)	P0705HD3 (1000mA)
		P0712HD2 (166mA)	P0712HD3 (250mA)	P0712HD5 (415mA)
12Vdc		P1203HD2 (500mA)	P1203HD3 (800mA)	P1205HD5 (1000mA)
		P1205HD2 (400mA)	P1205HD3 (600mA)	
24Vdc		P2403HD2 (500mA)	P2403HD3 (800mA)	P2405HD5 (1000mA)
		P2405HD2 (400mA)	P2405HD3 (600mA)	
36Vdc		P3605HD2 (400mA)	-	-

PIN CONFIGURATION

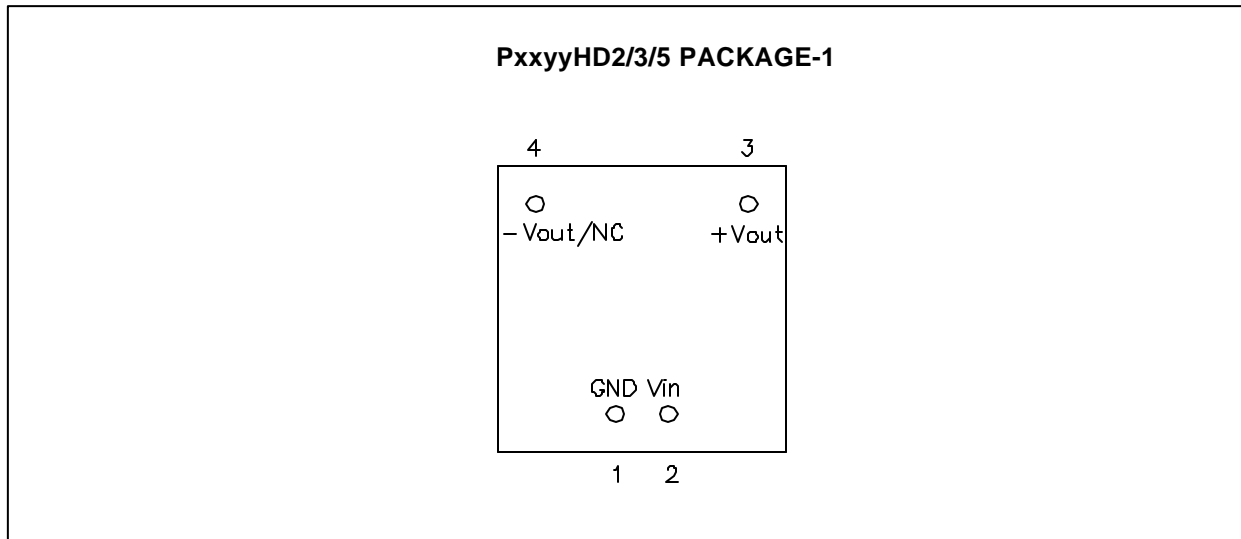

Mechanical Dimension: in inch (mm)

PxxyyHD2/3/5 PACKAGE-1 DIMENTIONS

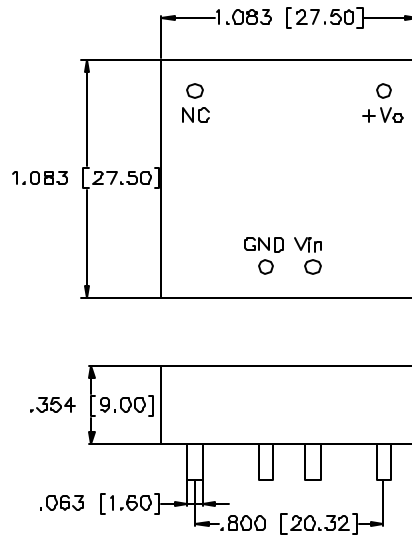

DIMENSIONAL RECOMMENDATIONS FOR PCB LAYOUT

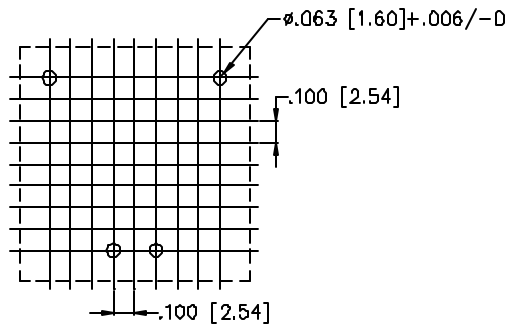

DIP PACKAGE DIMENSIONS

TECHNICAL DATA
 DATA SHEET 1110, REV. -

Mechanical Dimensions: in inch/mm & Pin Configuration

PxxyyHD2/3/5 PACKAGE-2 DIMENTIONS

