

PLEASE CHECK WWW.MOLEX.COM FOR LATEST PART INFORMATION

Part Number: [0561949028](#)
Status: **Active**
Description: CRC™ Shielded Rectangular I/O Female Terminal, Power, Chain

Documents:

[Drawing \(PDF\)](#) [RoHS Certificate of Compliance \(PDF\)](#)
[Product Specification PS-51300-005 \(PDF\)](#)

General

Product Family	I/O Connectors
Series	56194
Application	Panel-Mount, Wire-to-Wire
Component Type	Terminal
Product Name	CRC™
Type	N/A

Physical

Circuits (Loaded)	N/A
Gender	Female
Lock to Mating Part	Yes
Material - Plating Mating	Gold
Material - Plating Termination	Tin, Tin-Lead
Orientation	Vertical
Packaging Type	Reel
Panel Mount	N/A
Pitch - Mating Interface (in)	0.000 In
Pitch - Mating Interface (mm)	0.00 mm
Plating min: Mating (µin)	10
Plating min: Mating (µm)	0.25
Plating min: Termination (µin)	40
Plating min: Termination (µm)	1
Polarized to Mating Part	N/A
Temperature Range - Operating	-40°C to +105°C
Termination Interface: Style	Crimp or Compression
Wire Insulation Diameter	3.80mm (.150") max.
Wire Size AWG	14, 16, 18

Electrical

Current - Maximum per Contact	15A
Voltage - Maximum	250V

Material Info

Reference - Drawing Numbers

Product Specification	PS-51300-005
Sales Drawing	SD-56194-003



EU RoHS
ELV and RoHS
Compliant
REACH SVHC
 Not Reviewed
Halogen-Free
Status
 Not Reviewed

China RoHS



Need more information on product environmental compliance?

Email productcompliance@molex.com
 For a multiple part number RoHS Certificate of Compliance, [click here](#)

Please visit the [Contact Us](#) section for any non-product compliance questions.

Search Parts in this Series

56194Series

Mates With

56193 Plug Terminal

Use With

51300 , 51301 Housing . 51298 Hosing Kit

Application Tooling | FAQ

Tooling specifications and manuals are found by selecting the products below. Crimp Height Specifications are then contained in the Application Tooling Specification document.

Global

Description	Product #
Extraction Tool for Crimp Terminals	0638132800
Hand Tool for CRC™ (Compact Robot Connector) Power Crimp Sockets, 14-18 AWG	0638199900

Japan

Description

Product #

Extraction Tool

0574136000

This document was generated on 03/29/2010

PLEASE CHECK WWW.MOLEX.COM FOR LATEST PART INFORMATION

注記
NOTES

1. 材質
MATERIAL
銅合金 (板厚: 0.3)
COPPER ALLOY (THICKNESS : 0.3)
2. メッキ仕様
TERMINAL PLATING
接点部 : 金メッキ 0.25 μm MIN.
CONTACT AREA : GOLD 0.25 μm MIN.
圧着部 : 錫メッキ 1.0 μm MIN.
CRIMP AREA : TIN 1.0 μm MIN.
下地メッキ : ニッケルメッキ 1.27 μm MIN.
UNDER PLATE : NICKEL 1.27 μm MIN.
3. 適用電線範囲 : UL 1015 , AWG #18~14
APPLICABLE WIRE RANGE : UL 1015 , AWG #18~14
4. 被覆外径 : φ3.8 MAX.
INSULATION EXTERNAL DIA : φ3.8 MAX.
5. 適用ハウジング : 51300-**** , 51301-****
APPLICABLE HOUSING : 51300-**** , 51301-****
6. 適用圧着工具 (手動) : 57413-5300 (適用電線 : AWG #16~14)
APPLICABLE CRIMP TOOL (HAND) : 57413-5300 (APPLICABLE WIRE AWG #16~14)
: 57413-5400 (適用電線 : AWG #18)
: 57413-5400 (APPLICABLE WIRE AWG #18)
7. 本製品は 56194-9185 の鉛フリー品である。
THIS PRODUCT IS LEAD FREE OF 56194-9185.

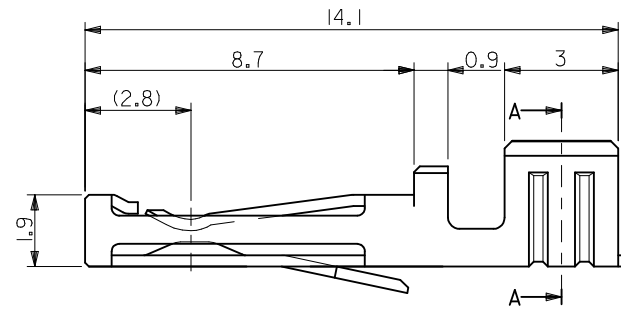
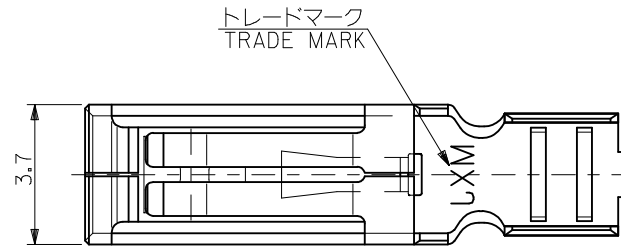
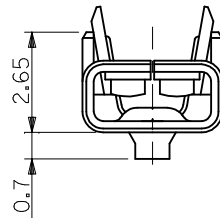
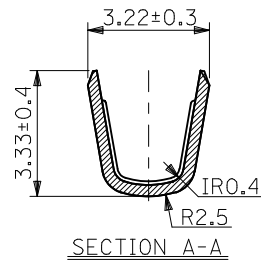

①	CHAIN	56194-9028	56194-9***
	バラ状 LOOSE	56194-9128	
	端子形状 TERMINAL CONFIGURATION	MATERIAL No.	MODEL No.

RELEASED EC NO: WNA2010-0098 DRWN: TMOELLER 2009/08/11 CHKD: MURPHY APPR: JFURPHY 2009/08/14 REV A	DESCRIPTION 10 UNDER ±0.2 10 OVER 30 UNDER ±0.25 30 OVER ±0.3 ANGULAR ±3 ° DRAFT WHERE APPLICABLE MUST REMAIN WITHIN DIMENSIONS	GENERAL TOLERANCES (UNLESS SPECIFIED)		DIMENSION STYLE	SCALE	DESIGN UNITS	THIRD ANGLE PROJECTION	
				MM ONLY	1:1	METRIC	⊙	
		DRAWN BY	DATE	TITLE				
		M. NABEI	'07/10/30	COMPACT ROBOT CONN. POWER CRIMP SOCKET -LEAD FREE-				
		CHECKED BY	DATE	MOLEX INCORPORATED				
M. ISOGAYA	'07/10/30	MATERIAL NO. SD-56194-003						
APPROVED BY	DATE	DOCUMENT NO.						
N. UKITA	'07/10/30	SHEET NO. 1 OF 1						
SIZE				THIS DRAWING CONTAINS INFORMATION THAT IS PROPRIETARY TO MOLEX INCORPORATED AND SHOULD NOT BE USED WITHOUT WRITTEN PERMISSION				
A3								