

G2N4403

PNP EPITAXIAL PLANAR TRANSISTOR

Description

The G2N4403 is designed for general purpose switching and amplifier applications.

Features

- *Complementary to G2N4401
- *High Power Dissipation: 625mW at 25°C
- *High DC Current Gain: 100-300 at 150mA
- *High Breakdown Voltage: 40V Min

Package Dimensions

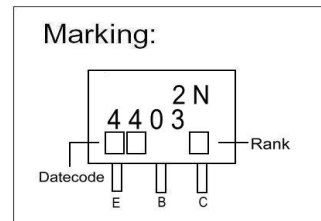
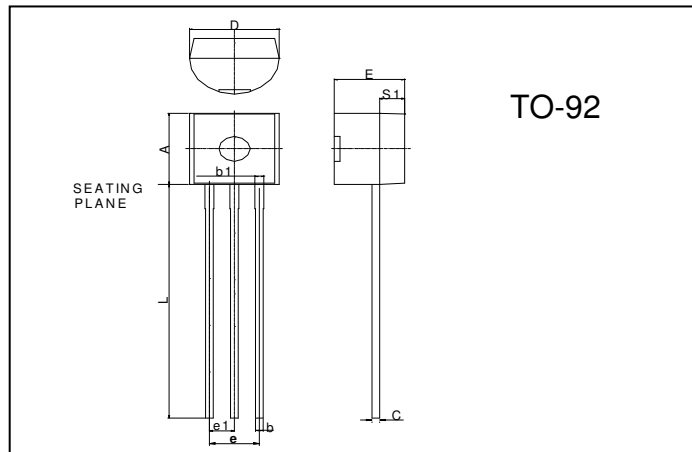

REF.	Millimeter		REF.	Millimeter	
	Min.	Max.		Min.	Max.
A	4.45	4.7	D	4.44	4.7
S1	1.02	-	E	3.30	3.81
b	0.36	0.51	L	12.70	-
b1	0.36	0.76	e1	1.150	1.390
C	0.36	0.51	e	2.42	2.66

Absolute Maximum Ratings at Ta = 25°C

Parameter	Symbol	Ratings	Unit
Junction Temperature	Tj	+150	°C
Storage Temperature	Tstg	-55 ~ +150	°C
Collector to Base Voltage	VCBO	-40	V
Collector to Emitter Voltage	VCEO	-40	V
Emitter to Base Voltage	VEBO	-5	V
Collector Current	IC	-600	mA
Total Power Dissipation	PD	625	mW

Characteristics at Ta = 25°C

Symbol	Min.	Typ.	Max.	Unit	Test Conditions
BVCBO	-40	-	-	V	IC=-100uA
BVCEO	-40	-	-	V	IC=-1mA
BVEBO	-5	-	-	V	IE=-10uA
ICEX	-	-	-100	nA	VCE=-35V, VBE=-0.4V
*VCE(sat)1	-	-	-0.4	V	IC=-150mA, IB=-15mA
*VCE(sat)2	-	-	-750	mV	IC=-500mA, IB=-15mA
*VBE(sat)1	-750	-	-950	mV	IC=-150mA, IB=-15mA
*VBE(sat)2	-	-	-1.3	V	IC=-500mA, IB=-50mA
*hFE1	30	-	-		VCE=-1V, IB=-0.1mA
*hFE2	60	-	-		VCE=-1V, IC=-1mA
*hFE3	100	-	-		VCE=-1V, IC=-10mA
*hFE4	100	-	300		VCE=-2V, IC=-150mA
*hFE5	20	-	-		VCE=-2V, IC=-500mA
fT	200	-	-	MHz	VCE=-10V, IC=-20mA, f=100MHz
Cob	-	-	8.5	pF	VCB=-10V, f=1MHz

Classification OF hFE4

* Pulse Test: Pulse Width ≤ 380us, Duty Cycle ≤ 2%

Rank	A	B
Range	100-210	190-300

Characteristics Curve

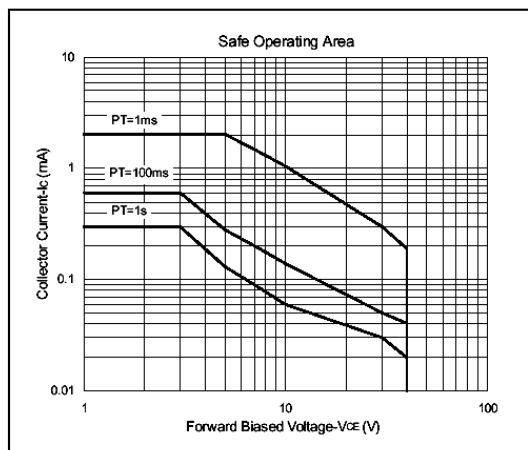
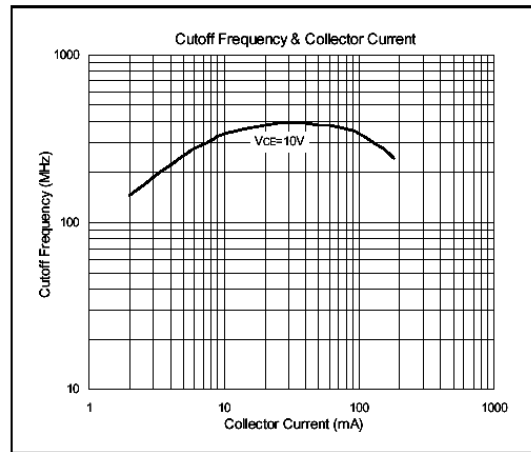
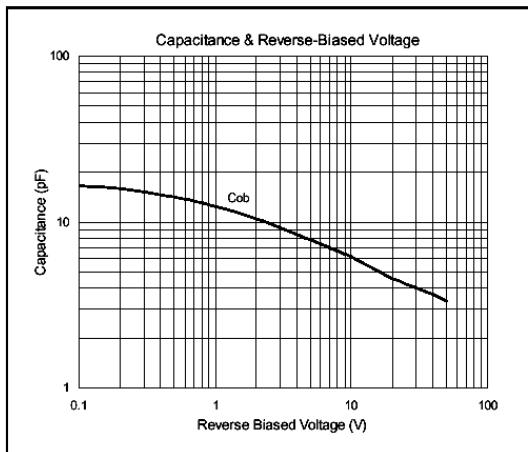
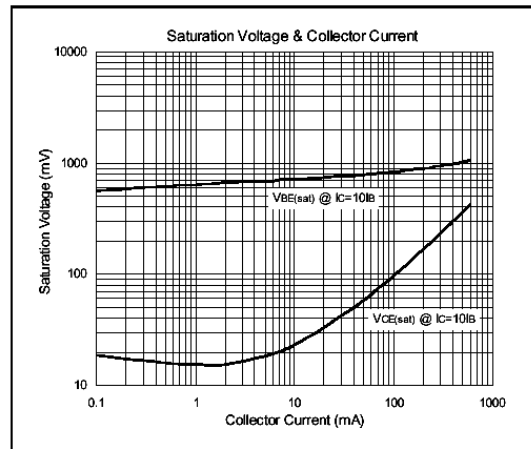
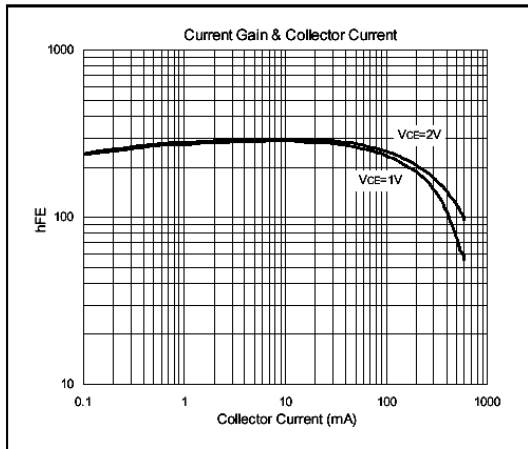

Important Notice:

- All rights are reserved. Reproduction in whole or in part is prohibited without the prior written approval of GTM.
- GTM reserves the right to make changes to its products without notice.
- GTM semiconductor products are not warranted to be suitable for use in life-support Applications, or systems.
- GTM assumes no liability for any consequence of customer product design, infringement of patents, or application assistance.

Head Office And Factory:

- **Taiwan:** No. 17-1 Tatung Rd. Fu Kou Hsin-Chu Industrial Park, Hsin-Chu, Taiwan, R. O. C.
- TEL : 886-3-597-7061 FAX : 886-3-597-9220, 597-0785
- **China:** (201203) No.255, Jang-Jiang Tsai-Lueng RD. , Pu-Dung-Hsin District, Shang-Hai City, China
- TEL : 86-21-5895-7671 ~ 4 FAX : 86-21-38950165