



# Model 3100-127 Precision Continuously Variable Attenuator

**dc to 2.0 GHz**  
**2 Watts**

## SMA Connector



### Features

- /// **Compact Size** - Smallest available precision variable attenuator with 127 dB incremental range. Provides the OEM with new flexibility in designing compact instrumentation.
- /// **Continuously Variable** - Attenuation is continuously variable between "minimum insertion loss (6 dB)" and 133 dB providing a 127 dB incremental range.
- /// **Rugged** - Designed to meet many requirements of MIL-A-24215.

### Specifications

**NOMINAL IMPEDANCE:** 50 Ω  
**FREQUENCY RANGE:** dc to 2.0 GHz  
**INCREMENTAL ATTENUATION RANGE:** 127 dB  
**CHARACTERISTIC INSERTION LOSS, RESIDUAL:**  
 6 ± 0.5 dB  
**CALIBRATION FREQUENCY/ACCURACY (including resetability):** ±0.5 dB or 1% whichever is greater. Test data is available at additional cost.  
**FREQUENCY SENSITIVITY:**  
 ± {0.015 x A x (F - Fd) + 0.5} or  
 ± {0.015 x A x (F - Fd) + 0.01 x A}  
 A = Attenuation setting in dB, Fd = Dial cut frequency in GHz,  
 F = Operation frequency in GHz  
**DIRECT READING DIAL CALIBRATED AT:** 1.0 GHz  
**DIAL INCREMENTS:** 2 dB increments from 6 to 130 dB plus 3 dB  
**RESOLUTION OF DIAL:** ~ 270° full scale (6 to 133 dB)  
**LIFE:** 50,000 Cycles (A cycle consists of a rotation from minimum to maximum and back to minimum).

#### MAXIMUM SWR (Input & Output):

Frequency (GHz)	SWR
dc - 2.0	1.60

#### PHASE SHIFT WITH CHANGE IN ATTENUATION:

$$\sim 1^\circ \text{ per dB} \times f(\text{GHz})$$

**POWER RATING:** 2 watts **average** to 25°C ambient temperature, derated linearly to 0 watts @ 85°C. 500 watts **peak** (5 μsec pulse width; 0.2% duty cycle)

**MAXIMUM STARTING TORQUE:** 30 inch ounces

**POWER COEFFICIENT:** <0.005 dB/dB/watt

**TEMPERATURE COEFFICIENT:** < 0.001 dB/dB/ °C

**TEMPERATURE RANGE:**

Operating: 0°C to 85°C

Non-operating: -55°C to 85°C.

**CONNECTOR:** SMA female connectors per MIL-STD-348 interface dimensions - mate nondestructively with MIL-C-39012 connectors.

**CONSTRUCTION:** Aluminum body and stainless steel connectors; gold plated beryllium copper contacts. Knob is included with each unit.

**WEIGHT:** 247 g (8.75 oz)

**PHYSICAL DIMENSIONS:**

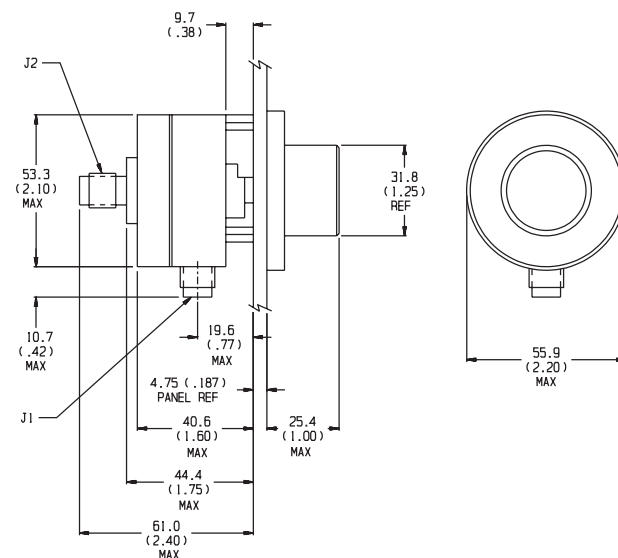
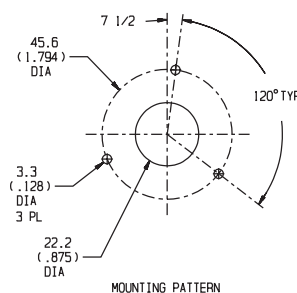

NOTE: All dimensions are given in mm (inches) and are maximum, unless otherwise specified.