

# 1.27mm PITCH DUAL ROW SOCKET TYPE

## (CENTRONIC TYPE)

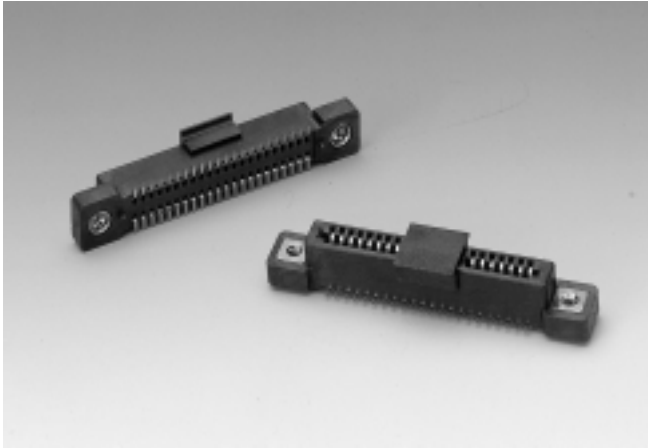

### 127260FA Series

Mates with P.C.B

#### Specifications:

- **Insulator material** : Black High Temp . Plastic
- **Max.Processing Temp.** : 230°C for 30 Seconds
- **Terminal Material** : Phosphor Bronze
- **Plating** : Full Gold Plated.
- **Max. Current Rating** : 1.0A
- **Voltage Rating** : 150V AC
- **Dielectric Strength** : 500V (Min. 60 seconds)

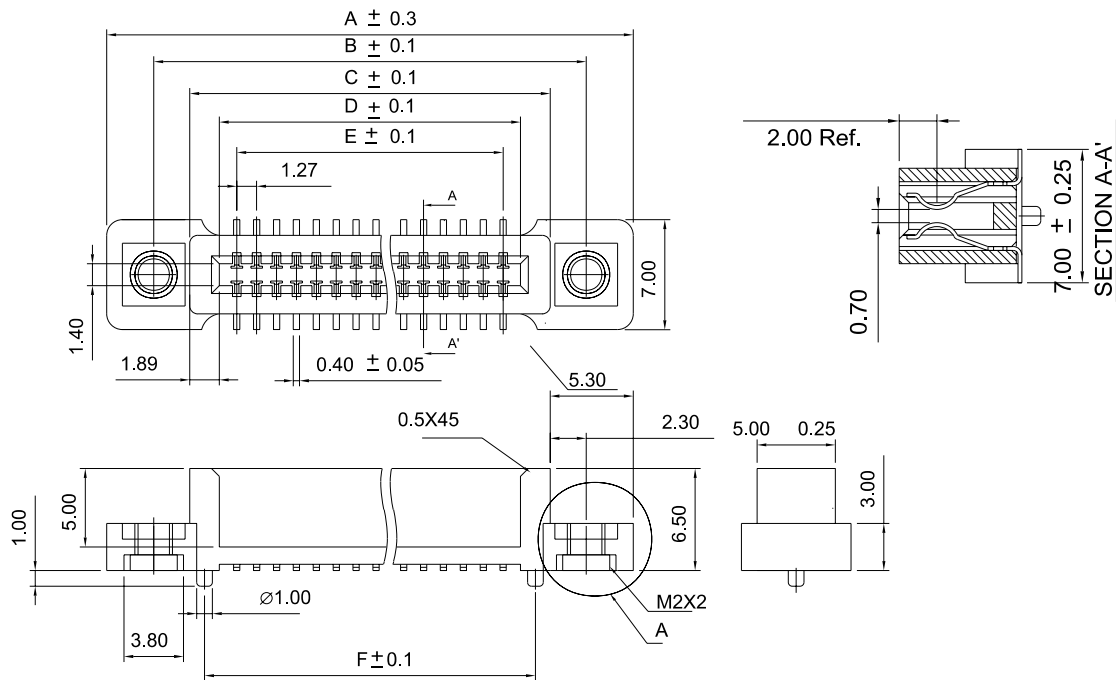

### Order Information

127260FA□□□□01ZU  
 1 2 3 4 5

1. 'A' : Straight SMT Type
2. No. of Pins
3. Plating
4. Color 'Z' : Black
5. Package

'U' : Tube Package Without CAP

Reference Page 11

### Recommended P.C.B. Layout

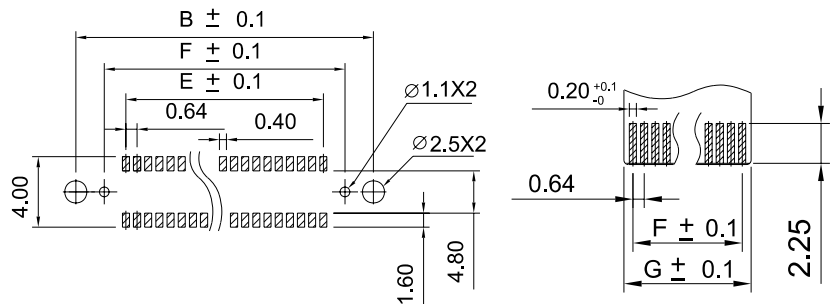

### Dimensional Information

SUYIN P/NO.	DIM.A	DIM.B	DIM.C	DIM.D	DIM.E	DIM.F	DIM.G
127260FA020□□01ZU	28.03	22.03	17.43	13.65	11.43	15.54	13.45
127260FA044□□01ZU	43.27	37.27	32.67	28.89	26.67	30.78	28.69
127260FA050□□01ZU	47.08	41.08	36.48	32.70	30.48	34.59	32.50