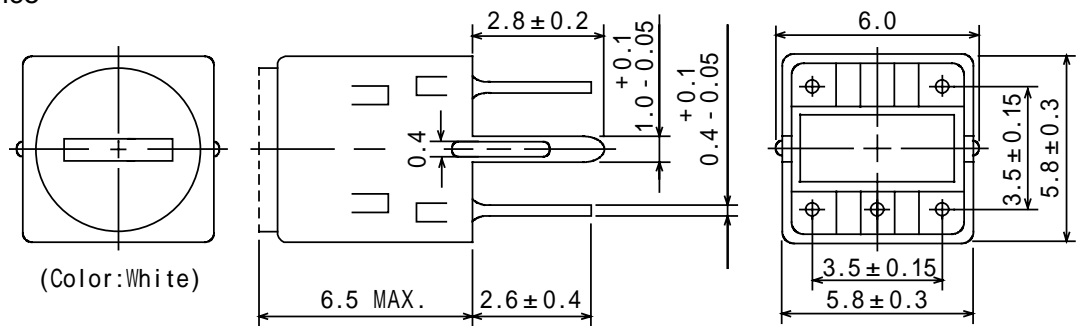

**Type: P-5LG/AM, P-5LG/MW, P-5LG/SW, P-5LG/FM**
**Product Description**

- 6.1 × 6.1mm Max.(L × W), 6.5mm Max. Height.
- Inductance:1~680 μ H Max.
- Operating frequency:20MHz Max.
- In addition to the reference versions of parameters shown here,custom designs are available to meet your exact requirements.

**Feature**

- Variable shielded high Q types.
- AM,MW,SW,FM types are all available.
- Internally assembled condenser is available.
- RoHS Compliance

**Dimension (mm)**

- \* Dimension does not include solder used on coil.
- \* Pin pitch shall be measured at the root of terminal.
- \* Dimension without tolerance are approx.

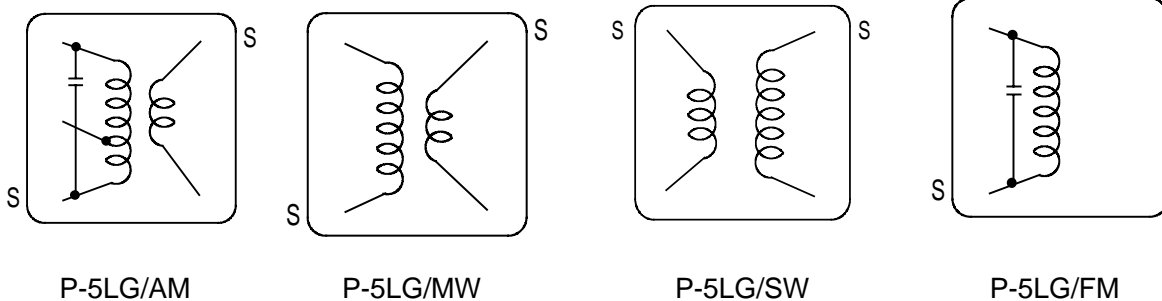
**Connection (Bottom View)**

“S” is winding start

**Type: P-5LG/AM, P-5LG/MW, P-5LG/SW , P-5LG/FM**
**Specification(P-5LG/AM)**

Item	( 1 - 3 )	Measuring Condition
Frequency	4 5 5 k H z ± 2 % Variable	
Capacity (Int.)	1 8 0 p F ± 1 0 %	
Unloaded Q	6 0 ± 2 0 % Within	4 5 5 k H z

**Specification(P-5LG/MW)**

Item	( 1 - 3 )	Measuring Condition
Inductance	3 6 0 μ H ± 4 % Variable	7 9 6 k H z
Unloaded Q	6 0 Min .	7 9 6 k H z

**Specification(P-5LG/SW)**

Item	( 4 - 6 )	Measuring Condition
Inductance	1 1 5 μ H ± 5 % Variable	7 9 6 k H z
Unloaded Q	5 0 Min .	7 9 6 k H z

**Specification(P-5LG/FM)**

Item	( 1 - 3 )	Measuring Condition
Frequency	1 0 . 7 M H z ± 2 % Variable	
Unloaded Q	5 5 Min .	1 0 . 7 M H z
Capacity (INT.)	5 1 p F ± 1 0 %	