

## 571-4154 Insulated solder terminal, Turreted, Feed thru

Recommended mounting hole .083 (2,11)

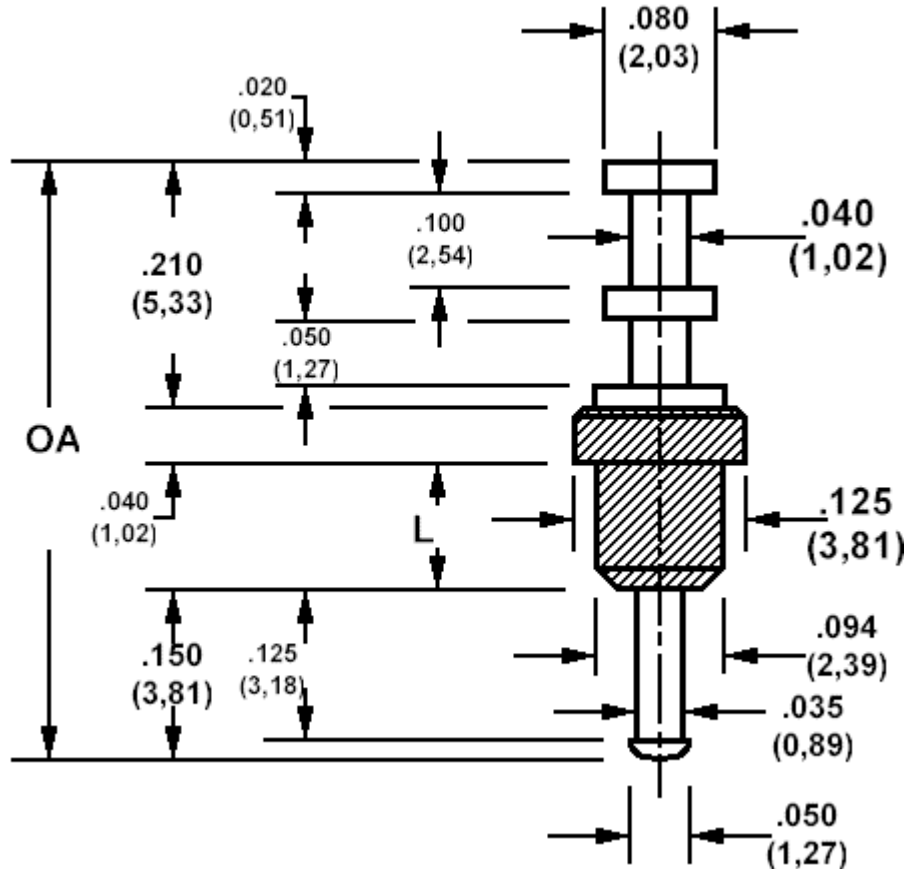

### How to order code

**571-4154-XX-YY-19**

Basic Part No (XX = Panel thickness, YY = plating finish. See tables for options)

Basic Part No.		OA(ref)	L	Panel Thickness (XX)
571-4154	-01	.460 (11,68)	.060 (1,52)	.016 (0,40) only
	-02	.500 (12,70)	.100 (2,54)	.031 (0,79) to .062 (1,59)

Component	Material	Finish <sub>t</sub> (YY)	
		-01	-05
Terminal	Brass	Silver	Electro Solder
Insulator	Teflon - white		

Additional Specifications	Panel thickness	
	-01	-02
Flashover VRMS at Sea Level	1500	1500
Capacitance (pF)	0.5	0.7

Teflon is a registered trademark of Dupont