

1. Mechanical Dimensions:

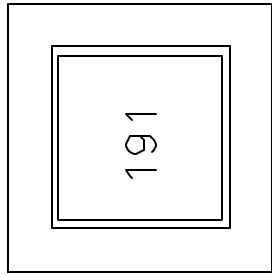

(Top View)

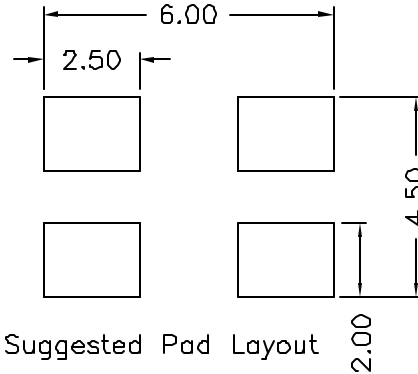
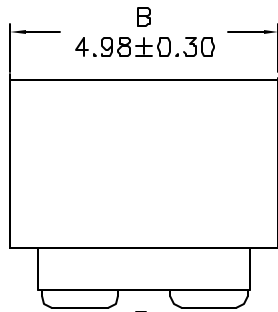
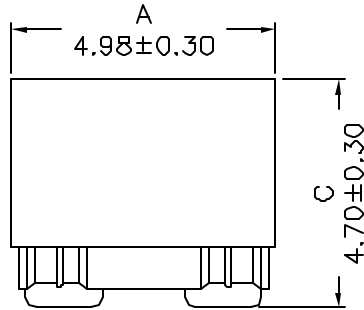

Suggested Pad Layout

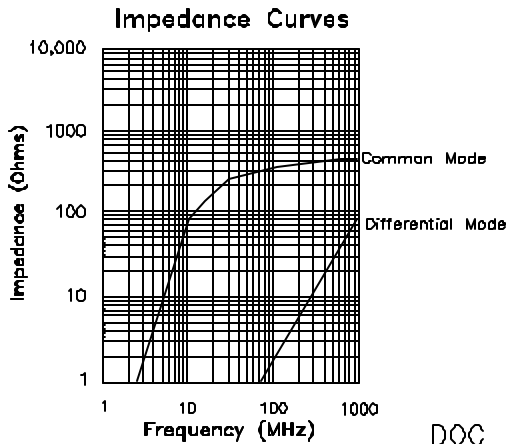
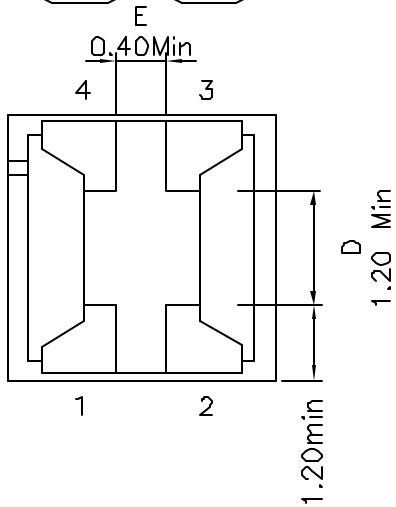

DOC REV: A/7

2. Schematic:

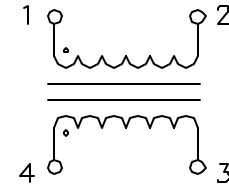

3. Electrical Specification:

Common Mode Impedance: 190 Ohms Typ @100MHz
 Rated Current: 5000mAac
 Rated Voltage: 50Vdc
 Insulation Resistance: 10 MOhms min
 Withstand Voltage: 125Vdc
 DC Resistance: 0.020 Ohms Max, Each Wdg

Notes:

1. Solderability: Leads shall meet MIL-STD-202G, Method 208H for solderability.
2. Flammability: UL94V-0
3. ASTM oxygen Index: > 28%
4. Insulation System: Class F 155°C. UL file E151556
5. Operating Temperature Range: All listed parameters are to be within tolerance from -40°C to +85°C
6. Storage Temperature Range: -55°C to +125°C
7. Aqueous wash compatible
8. SMD Lead Coplanarity: ±0.004" (0.102mm)
9. Electrical and mechanical specifications 100% tested
10. RoHS Compliant Component

XFMRs Inc www.XFMRs.com	Title: EMI filter		
	UNLESS OTHERWISE SPECIFIED	P/N: XFWCMC636347-191	Rev. A
TOLERANCES: .xx ±0.25. Dimensions in MM	DWN.	Juan Mao	Jul-30-07
	CHK.	YK Liao	Jul-30-07
Scale 2.5:1 SHT 1 OF 1	APP.	MS	Jul-30-07