

## INTRODUCTION

# molex® DuraClik™ SMT 2.00mm (.079") Pitch Wire-to-Board System Single Row, Positive Lock

DuraClik is a new 2.00mm Wire-to-Board connector system for the Automotive market that provides high tolerance to vibration. The connectors are finding use in automotive applications such as steering wheels, gear shifts and air conditioners.

These connectors feature an inner positive lock that provides space savings and prevents lock breakage or half-way locking. The positive lock provides an audible click to confirm mating.

These new connectors are available in 2-8 circuits, with more circuit sizes to be added soon. They include wide solder tabs for secure PCB retention, and polarization features to prevent mis-mating.

### Specifications:

- Current: 3.0A
- Voltage: 250V
- Contact Resistance: 20 milliohms max.
- Insulation Resistance: 1000 Megohms min.
- Dielectric Withstanding Voltage: 500V AC
- Operating Temperature: -40 to +105°C
- Packaging: Header — Embossed Tape  
Housing — Bag  
Terminals — Reel

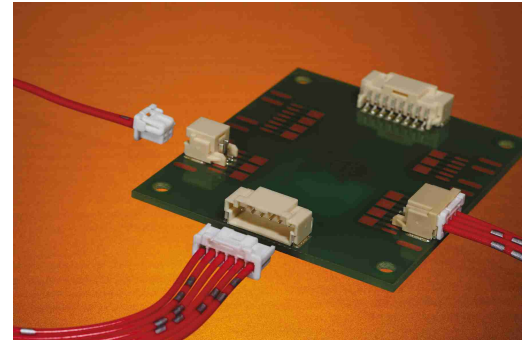

### Features

- Positive lock design
- Secure inner-lock system
- Wide/long end fitting solder nails
- SMT tail protector

### Benefits

- Audible click sound and tactile feel when the system locks
- Ensures complete connector locking, prevents breakage during handling and provides space savings over outer-locking systems
- Grounding and secure PCB retention to meet vibration requirements
- Prevents bent tails

### Grounding/Fitting Nail Feature

Solder nails are positioned on the end of the connector to absorb vibration

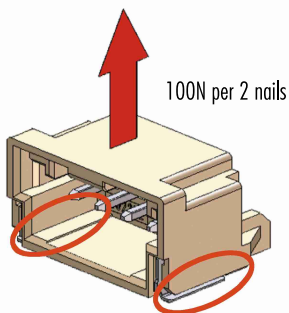

Shockproof SMT Design

### Inner Lock System

Inner Lock prevents lock breakage or half-way locking

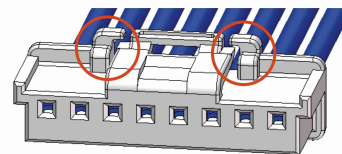

Anti-Fishhook Design

## AUTOMOTIVE APPLICATIONS

- Wiper/Blinker lever
- Shift lever
- Air conditioner
- Navigation meters
- Steering Wheel
- Switches

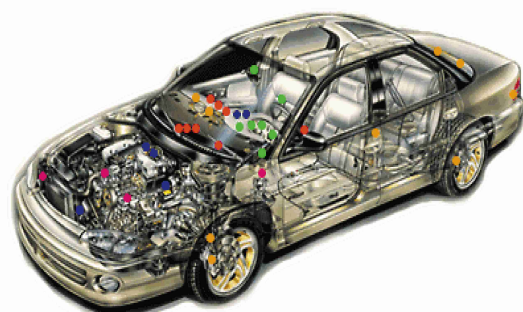

## ORDERING INFORMATION

**molex**® **DuraClik™ SMT**  
**2.00mm (.079") Pitch**  
**Wire-to-Board System**  
**Single Row, Positive Lock**

**Header**

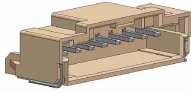

Order No.	Circuits	Height	Width
502352-0200	2	6.40mm (.252")	9.40mm (.370")
502352-0400	4		
502352-0600	6		
502352-0800	8		

**Housing**

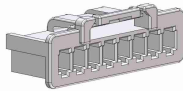

**Terminals**

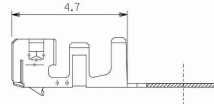

Order No.	Circuits	Height	Width	Terminal AWG 24-30	Terminal AWG 22-30
502351-0200	2	6.40mm (0.25")	9.40mm (.370")	50212-8000(reel) / 50212-8100(bag)	50372-8000(reel) / 50372-8100(bag)
502351-0400	4			50212-8000(reel) / 50212-8100(bag)	50372-8000(reel) / 50372-8100(bag)
502351-0600	6			50212-8000(reel) / 50212-8100(bag)	50372-8000(reel) / 50372-8100(bag)
502351-0800	8			50212-8000(reel) / 50212-8100(bag)	50372-8000(reel) / 50372-8100(bag)

**molex**®  
**one company** › a world of innovation

**Americas Headquarters**  
 2222 Wellington Ct,  
 Lisle, Illinois 60532 USA  
 Tel: 1-800-78MOLEX  
 amerinfo@molex.com

**Asia Pacific North Headquarters**  
 Yamato, Kanagawa, Japan  
 Tel: 81-46-265-2325  
 apninfo@molex.com

**Asia Pacific South Headquarters**  
 Jurong, Singapore  
 Tel: 65-6-268-6868  
 apsinfo@molex.com

**European Headquarters**  
 Munich, Germany  
 Tel: 49-89-413092-0  
 euroinfo@molex.com

**Corporate Headquarters**  
 2222 Wellington Ct,  
 Lisle, Illinois 60532 USA  
 Tel: 630-969-4550

Visit our website at [www.molex.com](http://www.molex.com)