

3.96mm (0.156") PITCH CONNECTOR

Wire-to-Board
Crimp Terminal

YT396J

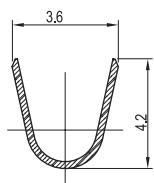
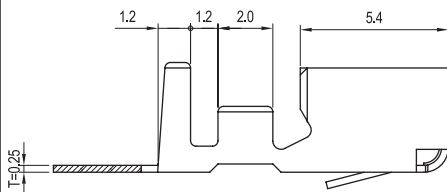
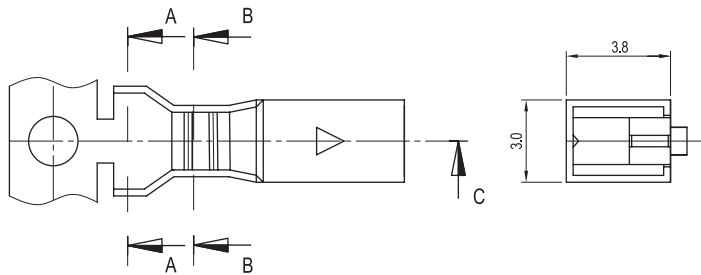
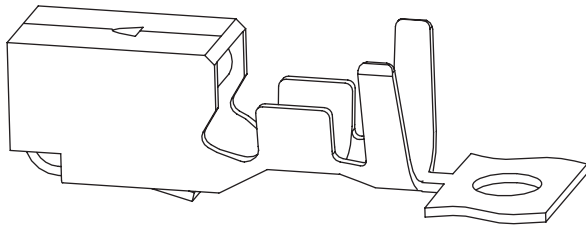

SECTION A-A

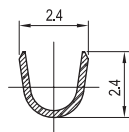

SECTION B-B

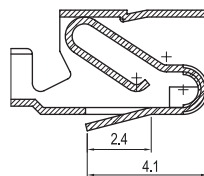

SECTION C-C

Material

I/NO	DESCRIPTION	TITLE	AWG	MATERIAL	FINISH
1	TERMINAL	YT396J	#16~#24	Brass	Tin-Plated

Specification

ITEM	SPEC
Voltage Rating	AC/DC 250V
Current Rating	AC/DC 7.5A
Operating Temperature	-25℃~+85℃
Contact Resistance	30mΩ MAX
Withstanding Voltage	AC1500V/1min
Insulation Resistance	1000MΩ MIN
Applicable Wire	AWG #16~#24
Applicable P.C.B	-
Applicable FPC/FFC	-
Solder Height	-
Crimp Tensile Strength	L-TYPE : AWG #16~#20
	M-TYPE : AWG #20~#24
	AWG #16 : 4.0kgfMIN
	AWG #18 : 3.5kgfMIN
	AWG #20 : 3.0kgfMIN
AWG #22 : 2.5kgfMIN	
AWG #24 : 2.0kgfMIN	
UL FILE NO	-